

NMRV蜗轮蜗杆减速机

伺服/步进专用减速机



■ NMRV系列蜗轮减速机



■ NMRV系列蜗轮减速机



■ DRV系列蜗轮减速机



■ DRV系列蜗轮减速机



■ UDL系列无级变速器



■ UDL系列无级变速器



■ UDL系列+NMRV系列蜗轮减速机



■ PC系列+NMRV系列蜗轮减速机



■ 配件+带输出法兰



■ 配件+带输出轴



■ 配件+带扭力臂



■ 配件+带防尘盖

NMRV 产品概述 / NMRV PRODUCTS OVERVIEW

产品特点

NMRV系列蜗轮蜗杆减速机具有以下一些主要特点：1. 优质铝合金铸造，重量轻，不生锈；2. 输出扭矩大；3. 传动平稳，噪音小，适合在恶劣环境中长期连续工作；4. 散热效率高；5. 美观耐用，体积小；6. 可适应全方位安装。

PRODUCTS CHARACTERISTICS

NMRV series worm gear units is a new-generation of product developed by our company on the basis of perfecting WJ series products with a compromise of advanced technology both at home and abroad. Its main features are as follows:

1. Made of high-quality aluminum alloy, light weight and non-rusting.
2. Large output torque.
3. Smooth in running and low in noise, can work long time in dreadful conditions.
4. High in radiating efficiency.
5. Good-looking in appearance, durable in service life and small in volume.
6. Suitable for omnibearing installation.

主要材料

1. 外壳：铝合金（机座：025 - 090），铸铁（机座：110 - 150）；
2. 蜗杆：20Cr，渗碳淬火，齿面硬度56 - 62HRC，精磨后保持渗碳层厚度0.3 - 0.5mm；
3. 蜗轮：耐磨锡青铜。

MAIN MATERIALS

1. Housing: die-cast aluminum alloy(frame size 025 to 090); cast iron(frame size:110 to 150);
2. Worm: 20Cr, carbonize&quencher heat treatment make the hardness of gear's surface up to 56-62HRC, retain carburization layer's thickness between 0.3 and 0.5mm after precise grinding.
3. Worm wheel: wearable stannum bronze alloy.

表面涂装

铝合金外壳：

1. 先抛丸处理，再经特种防腐处理，保持银白金属感，并耐汽油、二甲苯等有机溶剂的腐蚀；
2. 磷化处理后，再喷RAL5010蓝色或银白色涂料。

铸铁外壳：先涂红色防锈漆，后喷涂RAL5010蓝色涂料。

NMRV 结构分解图 / NMRV STRUCTURE DIAGRAM

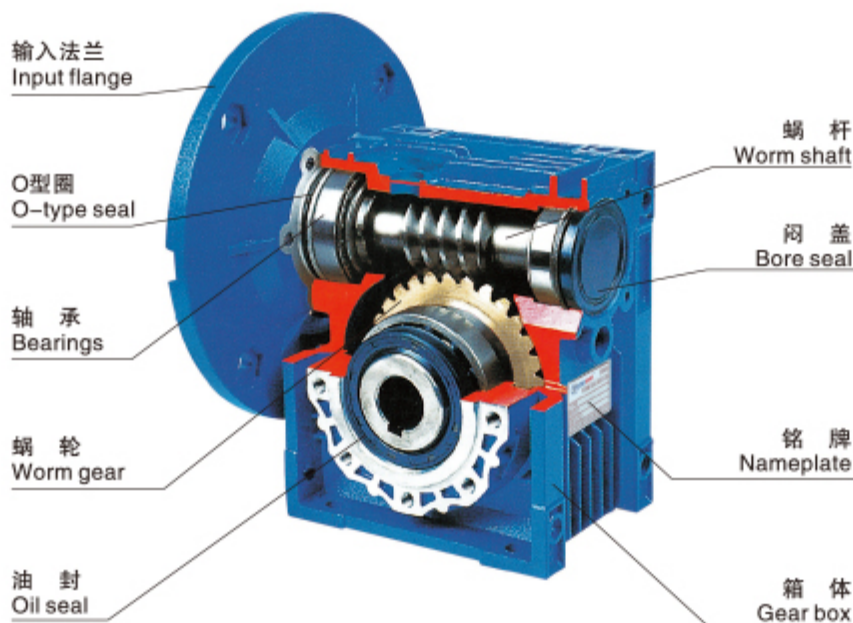

RV 蜗轮减速机
RV Worm-gear speed reducer

NMRV 型号说明 / NMRV MODEL ILLUMINATE



■ NMRV 系列蜗轮减速机

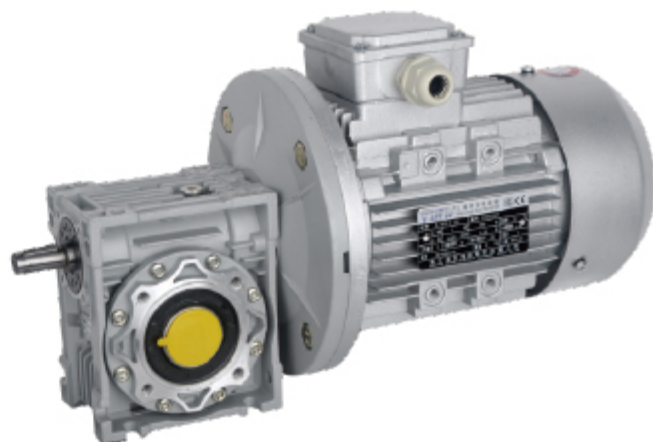

■ NMRV-E 系列蜗轮减速机

NMRV/NRV 蜗轮蜗杆减速电机与减速器

NMRV/NRV WORM GEARED MOTORS AND WORM GEAR UNITS

减速器 Gear unit

电机 Motor

| | | | | | | | | | | |
|-------------|------------|-----------|----------|------------|------------|-------------|-----------|------------------------|----------|----------|
| NMRV | 075 | 40 | E | FA1 | DZ1 | 80B5 | B3 | 8014或/or 0.55-4 | / | 1 |
| ① | ② | ③ | ④ | ⑤ | ⑥ | ⑦ | ⑧ | ⑨ | | ⑩ |

| No | 说 明 | Comments |
|----|--|---|
| 1 | 型号代码: 1.NMRV孔输入带输入法兰 2.NRV轴输入不带输入法兰 | Model code 1.NMRV:Hole input with flange 2.NRV:Shaft input without flange |
| 2 | 蜗轮蜗杆减速器中心距 (规格) | Central distance of worm gear units(spec) |
| 3 | 减速器速比 i=5,7.5,10,15,20,25,30,40,50,60,80,100. | Speed ratio of reducer (i=7.5;10;15;20;25;30;40;50;60;80;100) |
| 4 | 1.无代号表示不带蜗杆同向尾出轴 2.E: 带蜗杆同向尾出轴 | 1.No mark means single extension wormj shaft 2.E:Double extension worm shaft |
| 5 | 1.无代号表示不带输出法兰 2.FA, FB, FC, FD, FE (1/2) ; 输出法兰号和位置 | 1.No mark means without output flange 2.FA, FB, FC, FD, FE (1/2) ; output Flange and position |
| 6 | 1.无代号表示孔输出 2.DZ (1/2) ; 单向输出轴和位置 3.SZ: 双向输出轴 | 1.No mark means hole output 2.DZ(1/2):Single output shaft and position 3.SZ:Double output shaft |
| 7 | 输入法兰规格型式 (不带电机时) | Normalized from of input flange(without motor) |
| 8 | 安装方位代号 | Installation position code |
| 9 | 1.无代号表示不带电机 2.电机型号或功率, 极数 | 1.No mark means without motor 2.Model motos(poles of power) |
| 10 | 电机接线盒位置, 默认位置1可以不写 | Position diagram for motor terminal box default position 1 not to write out is ok |

NMRV减速机输入尺寸 / NMRV REDUCER INPUT SIZE

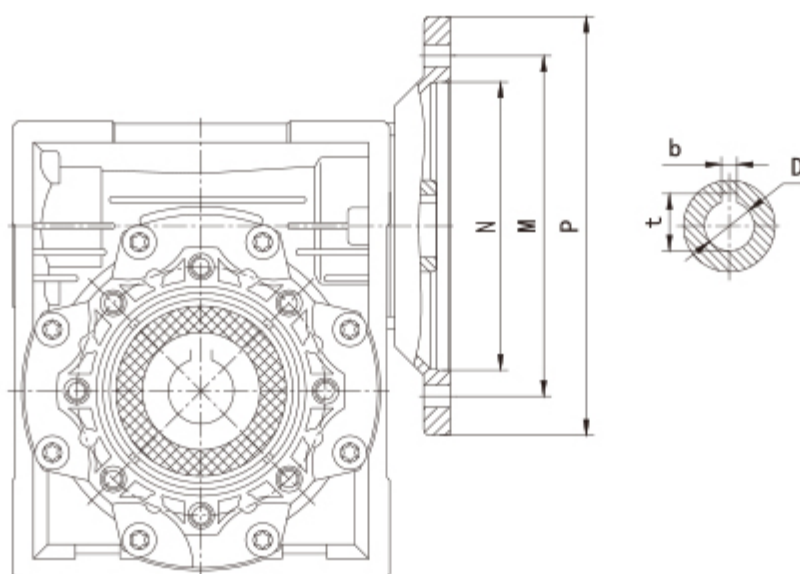

| NMRV | IEC接口 | | | | 键槽 | | 传动比 (i) | | | | | | | | | | | |
|------|------------|-----|-----|-----|----|------|---------|-----|----|----|----|----|----|----|----|----|----|-----|
| | PAM-IEC | N | M | P | b | t | 5 | 7.5 | 10 | 15 | 20 | 25 | 30 | 40 | 50 | 60 | 80 | 100 |
| | | | | | | | 孔径 (D) | | | | | | | | | | | |
| 025 | 56B14 | 50 | 65 | 80 | 3 | 10.4 | 9 | 9 | 9 | 9 | 9 | / | 9 | 9 | 9 | 9 | / | / |
| 030 | 56B14 | 50 | 65 | 80 | 3 | 10.4 | 9 | 9 | 9 | 9 | 9 | 9 | 9 | 9 | 9 | 9 | 9 | / |
| | 56B5 | 80 | 100 | 120 | 4 | 12.8 | 11 | 11 | 11 | 11 | 11 | 11 | 11 | 11 | 11 | / | / | / |
| | 63B14 | 60 | 75 | 90 | | | | | | | | | | | | | | |
| | 63B5 | 95 | 115 | 140 | | | | | | | | | | | | | | |
| 040 | 56B5 | 80 | 100 | 120 | 3 | 10.4 | / | / | / | / | / | / | / | / | 9 | 9 | 9 | 9 |
| | 63B14 | 60 | 75 | 90 | 4 | 12.8 | 11 | 11 | 11 | 11 | 11 | 11 | 11 | 11 | 11 | 11 | 11 | 11 |
| | 63B5 | 95 | 115 | 140 | | | | | | | | | | | | | | |
| | 71B14 | 70 | 85 | 105 | 5 | 16.3 | 14 | 14 | 14 | 14 | 14 | 14 | 14 | 14 | / | / | / | / |
| | 71B5 | 110 | 130 | 160 | | | | | | | | | | | | | | |
| 050 | 63B5 | 95 | 115 | 140 | 4 | 12.8 | / | / | / | / | / | / | / | 11 | 11 | 11 | 11 | 11 |
| | 71B14 | 70 | 85 | 105 | 5 | 16.3 | 14 | 14 | 14 | 14 | 14 | 14 | 14 | 14 | 14 | 14 | 14 | / |
| | 71B5 | 110 | 130 | 160 | | | | | | | | | | | | | | |
| | 80B14 | 80 | 100 | 120 | 6 | 21.8 | 19 | 19 | 19 | 19 | 19 | 19 | 19 | / | / | / | / | / |
| | 80B5 | 130 | 165 | 200 | | | | | | | | | | | | | | |
| 063 | 71B14 | 70 | 85 | 105 | 5 | 16.3 | / | / | / | / | / | / | / | 14 | 14 | 14 | 14 | 14 |
| | 71B5 | 110 | 130 | 160 | | | | | | | | | | | | | | |
| | 80B14 | 80 | 100 | 120 | 6 | 21.8 | / | 19 | 19 | 19 | 19 | 19 | 19 | 19 | 19 | 19 | 19 | 19 |
| | 80B5 | 130 | 165 | 200 | | | | | | | | | | | | | | |
| | 90B14 | 95 | 115 | 140 | 8 | 27.3 | / | 24 | 24 | 24 | 24 | 24 | 24 | / | / | / | / | / |
| | 90B5 | 130 | 165 | 200 | | | | | | | | | | | | | | |
| 075 | 71B5 | 110 | 130 | 160 | 5 | 16.3 | / | / | / | / | / | / | / | / | 14 | 14 | 14 | 14 |
| | 80B14 | 80 | 100 | 120 | 6 | 21.8 | / | / | / | / | 19 | 19 | 19 | 19 | 19 | 19 | 19 | 19 |
| | 80B5 | 130 | 165 | 200 | | | | | | | | | | | | | | |
| | 90B14 | 95 | 115 | 140 | 8 | 27.3 | / | 24 | 24 | 24 | 24 | 24 | 24 | 24 | / | / | / | / |
| | 90B5 | 130 | 165 | 200 | | | | | | | | | | | | | | |
| | 100/112B14 | 110 | 130 | 160 | 8 | 31.3 | / | 28 | 28 | 28 | / | / | / | / | / | / | / | / |
| | 100/112B5 | 180 | 215 | 250 | | | | | | | | | | | | | | |
| 090 | 80B14 | 80 | 100 | 120 | 6 | 21.8 | / | / | / | / | / | / | / | 19 | 19 | 19 | 19 | 19 |
| | 80B5 | 130 | 165 | 200 | | | | | | | | | | | | | | |
| | 90B14 | 95 | 115 | 140 | 8 | 27.3 | / | / | / | / | / | 24 | 24 | 24 | 24 | 24 | / | / |
| | 90B5 | 130 | 165 | 200 | | | | | | | | | | | | | | |
| | 100/112B14 | 110 | 130 | 160 | 8 | 31.3 | / | 28 | 28 | 28 | 28 | 28 | 28 | / | / | / | / | / |
| | 100/112B5 | 180 | 215 | 250 | | | | | | | | | | | | | | |
| 110 | 80B5 | 130 | 165 | 200 | 8 | 21.8 | / | / | / | / | / | / | / | / | / | / | 19 | 19 |
| | 90B5 | 130 | 165 | 200 | 8 | 27.3 | / | / | / | / | / | / | 24 | 24 | 24 | 24 | 24 | 24 |
| | 100/112B5 | 180 | 215 | 250 | 8 | 31.3 | / | 28 | 28 | 28 | 28 | 28 | 28 | 28 | 28 | 28 | / | / |
| | 132B5 | 230 | 265 | 300 | 10 | 41.3 | / | 38 | 38 | 38 | 38 | / | / | / | / | / | / | / |
| 130 | 90B5 | 130 | 165 | 200 | 8 | 27.3 | / | / | / | / | / | / | / | / | / | / | 24 | 24 |
| | 100/112B5 | 180 | 215 | 250 | 8 | 31.3 | / | / | / | / | / | 28 | 28 | 28 | 28 | 28 | 28 | 28 |
| | 132B5 | 230 | 265 | 300 | 10 | 41.3 | / | 38 | 38 | 38 | 38 | 38 | 38 | 38 | / | / | / | / |
| 150 | 100/112B5 | 180 | 215 | 250 | 8 | 31.3 | / | / | / | / | / | / | / | / | 28 | 28 | 28 | 28 |
| | 132B5 | 230 | 265 | 300 | 10 | 41.3 | / | / | / | / | 38 | 38 | 38 | 38 | 38 | 38 | / | / |
| | 160B5 | 250 | 300 | 350 | 12 | 45.3 | / | 42 | 42 | 42 | 42 | 42 | / | / | / | / | / | / |

NMRV 减速机配件安装方位

NMRV ACCESSORIES INSTALLATION POSITION

输出轴位置 / THE OUTPUT SHAFT POSITION



DZ1



DZ2



SZ

注: 如没有特别说明, 将按照如图DZ1和B3安装方面的组合样式供货。

Note: If there is no special instructions, will be as shown in figure DZ1 and B3 mounted with respect to the combination of styles available.

输出法兰位置 / OUTPUT FLANGE POSITION

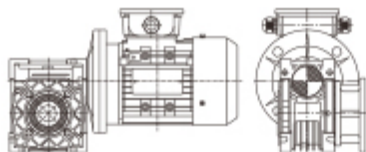

FA1、FB1、FC1、FD1、FE1

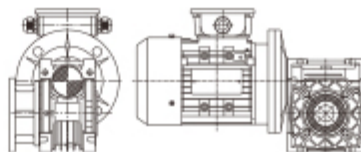

FA2、FB2、FC2、FD2、FE2

注: 如没有特别说明, 将按照如图F...1和B3安装方面的组合样式供货。

Note: If there is no special instructions, will be in accordance with the figure F... 1 and B3 mounted with respect to the combination of styles available.

电机接线盒位置 / MOTOR TERMINAL BOX POSITION

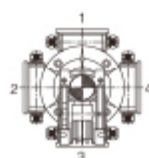
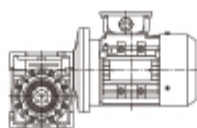
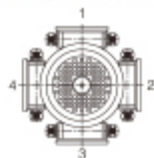

注: 如对电机接线盒位置有特别要求, 订购时须参考上图的要求指定接线盒方位, 否则接线盒方位将按安装方位图表中的方位提供。

Note: If the motor terminal box position have special requirements, when ordering reference is made to the above requirements specified terminal box position, or junction box range according to installation position chart position is provided.

扭力臂(A)位置 / TORQUE ARM (A) POSITION



A1



A2

注: 如没有特别说明, 将按照如图A1和B3安装方面的组合样式供货。

Note: If there is no special instructions, will be as shown in figure A1 and B3 mounted with respect to the combination of styles available.

尾出轴(E) / TAIL SHAFT (E) POSITION



NMRV与电机安装方位 / NMRV AND MOTOR MOUNTING POSITION

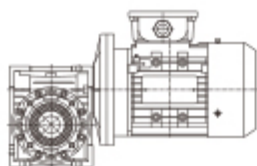

B3

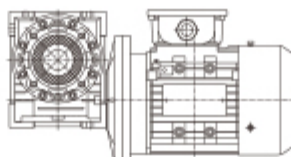

B8

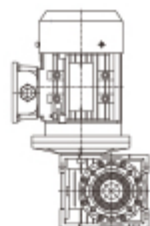

V5

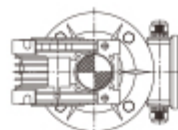

B6

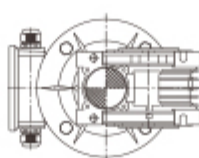

B7

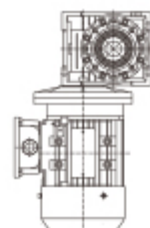

V6

注: 如在订货时无特别说明, 将按B3安装方式供货。

Note: if there is no special instructions to B3 standards for installation.

NMRV配件系列 / NMRV ACCESSORIES SERIES

输出轴尺寸 / OUTPUT SHAFT SIZE

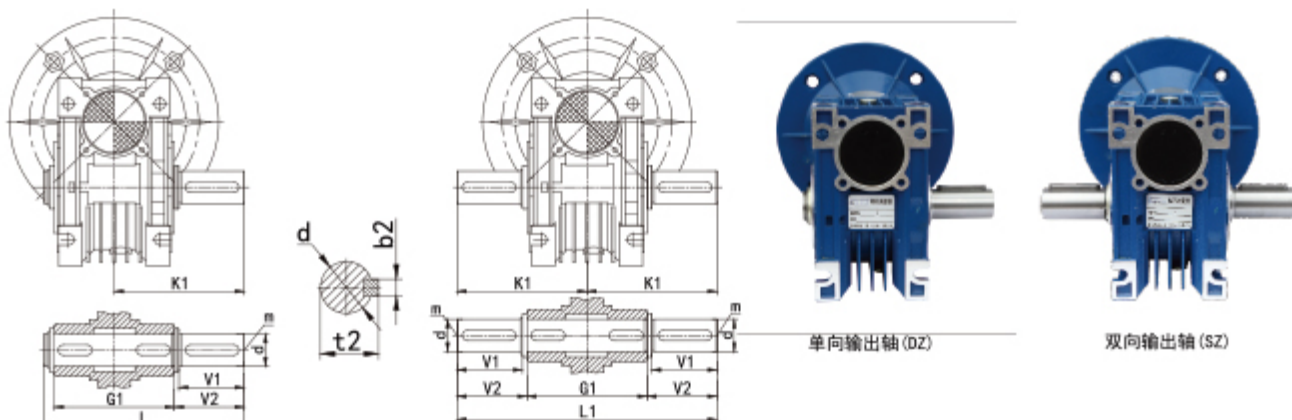

| NMRV | G1 | K1 | L | L1 | b2 | t2 | d(h6) | m | V1 | V2 |
|------|-----|-------|-----|-----|----|------|-------|-----|----|------|
| 030 | 63 | 64 | 102 | 128 | 5 | 16 | 14 | M6 | 30 | 32.5 |
| 040 | 78 | 82 | 128 | 164 | 6 | 20.5 | 18 | M6 | 40 | 43 |
| 050 | 92 | 99.5 | 153 | 199 | 8 | 28 | 25 | M10 | 50 | 53.5 |
| 063 | 112 | 109.5 | 173 | 219 | 8 | 28 | 25 | M10 | 50 | 53.5 |
| 075 | 120 | 123.5 | 192 | 247 | 8 | 31 | 28 | M10 | 60 | 63.5 |
| 090 | 140 | 154.5 | 234 | 309 | 10 | 38 | 35 | M12 | 80 | 84.5 |
| 110 | 155 | 162 | 249 | 324 | 12 | 45 | 42 | M16 | 80 | 84.5 |
| 130 | 170 | 170 | 265 | 340 | 14 | 48.5 | 45 | M16 | 80 | 85 |
| 150 | 200 | 187 | 297 | 374 | 14 | 53.5 | 50 | M16 | 82 | 87 |

扭力臂 (A) 尺寸 / TORQUE ARM (A) SIZE

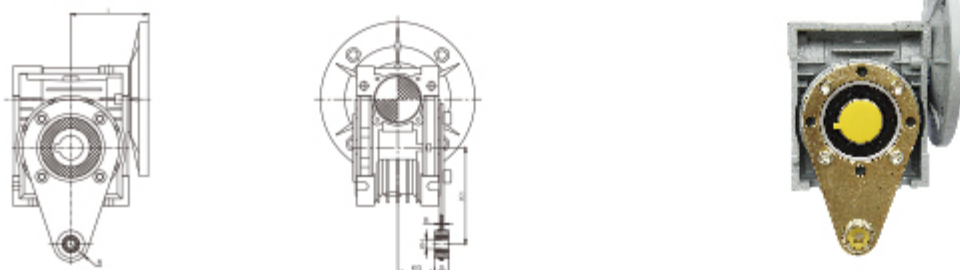

| NMRV | B | I | K1 | G | KG | KH | R |
|------|---|-------|-----|----|------|----|----|
| 025 | 4 | 45 | 70 | 14 | 17.5 | 8 | 15 |
| 030 | 4 | 55 | 85 | 14 | 24 | 8 | 15 |
| 040 | 4 | 70 | 100 | 14 | 31.5 | 10 | 18 |
| 050 | 4 | 80 | 100 | 14 | 38.5 | 10 | 18 |
| 063 | 6 | 95 | 150 | 14 | 49 | 10 | 18 |
| 075 | 6 | 112.5 | 200 | 25 | 47.5 | 20 | 30 |
| 090 | 6 | 129.5 | 200 | 25 | 57.5 | 20 | 30 |
| 110 | 6 | 160 | 250 | 30 | 62 | 25 | 35 |
| 130 | 6 | 179 | 250 | 30 | 69 | 25 | 35 |
| 150 | 8 | 210 | 250 | 30 | 84 | 25 | 35 |

防尘盖尺寸 / DUST COVER SIZE

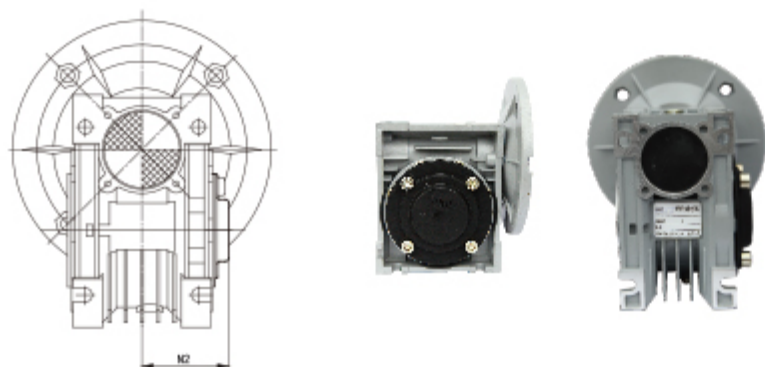

| NMRV | N2 |
|------|-----|
| 030 | 42 |
| 040 | 50 |
| 050 | 58 |
| 063 | 69 |
| 075 | 74 |
| 090 | 85 |
| 110 | 94 |
| 130 | 102 |
| 150 | 117 |

NMRV配件系列 / NMRV ACCESSORIES SERIES

输出法兰 (F) 尺寸 / OUTPUT FLANGE DIMENSIONS (F)

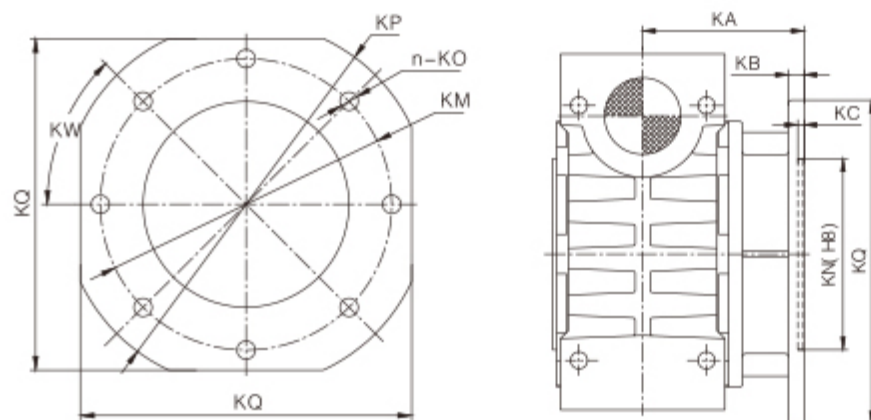

| NMRV | | 030 | 040 | 050 | 063 | 075 | 090 | 110 | 130 | 150 |
|------|----|----------|----------|----------|---------|---------|---------|---------|---------|---------|
| FA | KA | 54.5 | 67 | 90 | 82 | 111 | 111 | 139 | 152 | 155 |
| | KB | 6 | 7 | 9 | 10 | 13 | 13 | 15 | 15 | 15 |
| | KC | 4 | 4 | 5 | 6 | 6 | 6 | 6 | 6 | 6 |
| | KN | 50 | 60 | 70 | 115 | 130 | 152 | 170 | 180 | 180 |
| | KM | 68 | 75 | 85 | 150 | 165 | 175 | 230 | 255 | 255 |
| | KO | 6.5(n=4) | 9(n=4) | 11(n=4) | 11(n=4) | 14(n=4) | 14(n=4) | 14(n=8) | 16(n=8) | 16(n=8) |
| | KP | 80 | 110 | 125 | 180 | 200 | 210 | 280 | 320 | 320 |
| | KQ | 70 | 95 | 110 | 142 | 170 | 200 | 260 | 290 | 290 |
| | KW | 45° | 45° | 45° | 45° | 45° | 45° | 45° | 45° | 22.5° |
| FB | KA | - | 97 | 120 | 112 | - | 122 | - | - | - |
| | KB | - | 7 | 9 | 10 | - | 18 | - | - | - |
| | KC | - | 4 | 5 | 6 | - | 6 | - | - | - |
| | KN | - | 60 | 70 | 115 | - | 180 | - | - | - |
| | KM | - | 75 | 85 | 150 | - | 215 | - | - | - |
| | KO | - | 9(n=4) | 11(n=4) | 11(n=4) | - | 14(n=4) | - | - | - |
| | KP | - | 110 | 125 | 180 | - | 250 | - | - | - |
| | KQ | - | 95 | 110 | 142 | - | - | - | - | - |
| | KW | - | 45° | 45° | 45° | - | 45° | - | - | - |
| FC | KA | - | 80 | 89 | 98 | - | 110 | - | - | - |
| | KB | - | 9 | 10 | 10 | - | 17 | - | - | - |
| | KC | - | 5 | 5 | 5 | - | 6 | - | - | - |
| | KN | - | 95 | 110 | 130 | - | 130 | - | - | - |
| | KM | - | 115 | 130 | 165 | - | 165 | - | - | - |
| | KO | - | 9.5(n=4) | 9.5(n=4) | 11(n=4) | - | 11(n=4) | - | - | - |
| | KP | - | 140 | 160 | 200 | - | 200 | - | - | - |
| | KW | - | 45° | 45° | 45° | - | 45° | - | - | - |
| FD | KA | - | 58 | 72 | 107 | - | 151 | - | - | - |
| | KB | - | 12 | 14.5 | 10 | - | 13 | - | - | - |
| | KC | - | 5 | 5 | 5 | - | 6 | - | - | - |
| | KN | - | 80 | 95 | 130 | - | 152 | - | - | - |
| | KM | - | 100 | 115 | 165 | - | 175 | - | - | - |
| | KO | - | 9(n=4) | 11(n=4) | 11(n=4) | - | 14(n=4) | - | - | - |
| | KP | - | 120 | 140 | 200 | - | 210 | - | - | - |
| | KW | - | 45° | 45° | 45° | - | 45° | - | - | - |
| FE | KA | - | - | - | 80.5 | - | - | - | - | - |
| | KB | - | - | - | 16.5 | - | - | - | - | - |
| | KC | - | - | - | 5 | - | - | - | - | - |
| | KN | - | - | - | 110 | - | - | - | - | - |
| | KM | - | - | - | 130 | - | - | - | - | - |
| | KO | - | - | - | 11(n=4) | - | - | - | - | - |
| | KP | - | - | - | 160 | - | - | - | - | - |
| | KW | - | - | - | 45° | - | - | - | - | - |

RV 产品介绍 / RV PRODUCT INTRODUCTION

RV尺寸/ RV SIZE

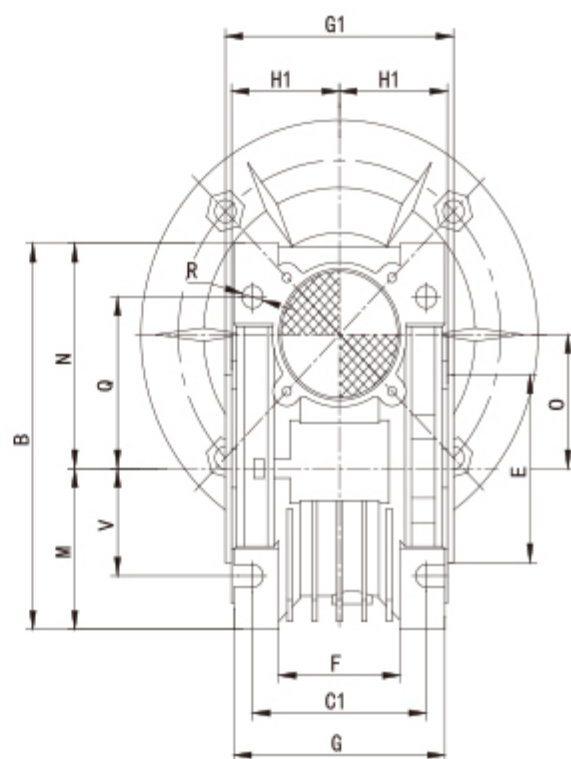
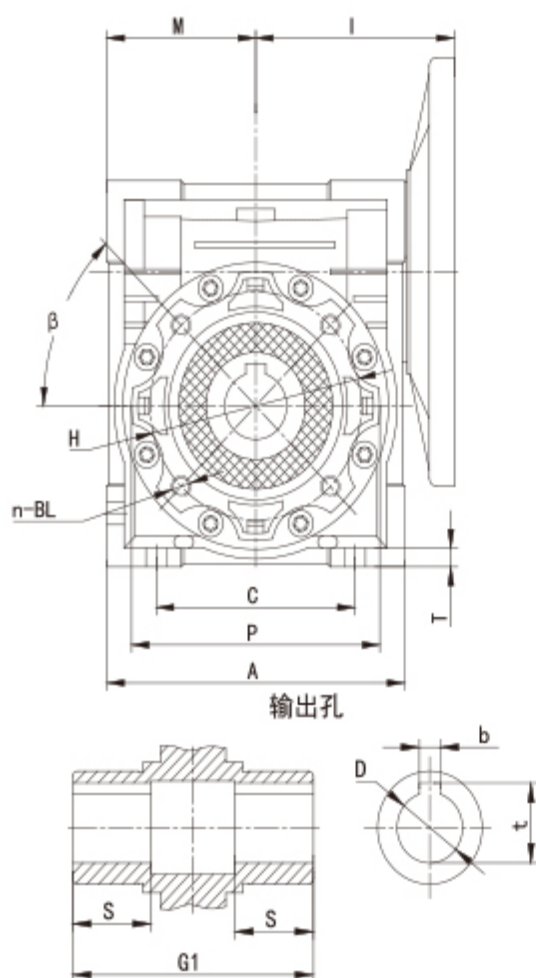

| RV | A | B | C | C1 | D(H8) | E(h8) | F | G | G1 | H | H1 | I | M | N | O | P | Q | R | S | T | BL | β | b | t | V |
|-----|-----|-------|-----|-----|--------|-------|----|-----|-----|-----|------|-------|-------|-------|-----|-----|-----|-----|------|-----|--------------|---------|-------|------------|-----|
| 030 | 80 | 97 | 54 | 44 | 14 | 55 | 32 | 56 | 63 | 65 | 29 | 55 | 40 | 57 | 30 | 75 | 44 | 6.5 | 21 | 5.5 | M6X10 (n=4) | 0° | 5 | 16.3 | 27 |
| 040 | 100 | 121.5 | 70 | 60 | 18(19) | 60 | 43 | 71 | 78 | 75 | 36.5 | 70 | 50 | 71.5 | 40 | 87 | 55 | 6.5 | 26 | 6.5 | M6X10 (n=4) | 45° | 6 | 20.8(21.8) | 35 |
| 050 | 120 | 144 | 80 | 70 | 25(24) | 70 | 49 | 85 | 92 | 85 | 43.5 | 80 | 60 | 84 | 50 | 100 | 64 | 8.5 | 30 | 7 | M8X12 (n=4) | 45° | 8 | 28.3(27.3) | 40 |
| 063 | 144 | 174 | 100 | 85 | 25(28) | 80 | 67 | 103 | 112 | 95 | 53 | 95 | 72 | 102 | 63 | 110 | 80 | 8.5 | 36 | 8 | M8X12 (n=8) | 45° | 8 | 28.3(31.3) | 50 |
| 075 | 172 | 205 | 120 | 90 | 28(35) | 95 | 72 | 112 | 120 | 115 | 57 | 112.5 | 86 | 119 | 75 | 140 | 93 | 11 | 40 | 10 | M8X14 (n=8) | 45° | 8(10) | 31.3(38.3) | 60 |
| 090 | 206 | 238 | 140 | 100 | 35(38) | 110 | 74 | 130 | 140 | 130 | 67 | 129.5 | 103 | 135 | 90 | 160 | 102 | 13 | 45 | 11 | M10X16 (n=8) | 45° | 10 | 38.3(41.3) | 70 |
| 110 | 255 | 295 | 170 | 115 | 42 | 130 | — | 144 | 155 | 165 | 74 | 160 | 127.5 | 167.5 | 110 | 200 | 125 | 14 | 50 | 14 | M10X18 (n=8) | 45° | 12 | 45.3 | 85 |
| 130 | 293 | 335 | 200 | 120 | 45 | 180 | — | 155 | 170 | 215 | 81 | 179 | 146.5 | 187.5 | 130 | 250 | 140 | 16 | 60 | 15 | M12X20 (n=8) | 45° | 14 | 48.8 | 100 |
| 150 | 340 | 400 | 240 | 145 | 50 | 180 | — | 185 | 200 | 215 | 96 | 210 | 170 | 230 | 150 | 250 | 180 | 18 | 72.5 | 18 | M12X22 (n=8) | 45° | 14 | 53.8 | 120 |

RV-E产品介绍 / RV-E PRODUCT INTRODUCTION

RV-E尺寸 / RV-E SIZE

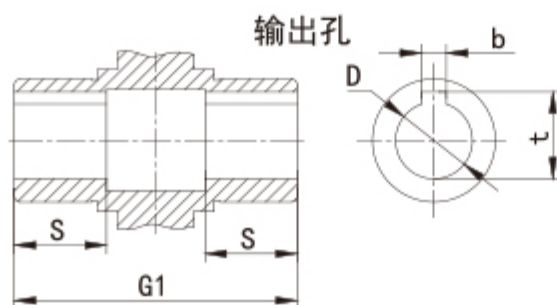
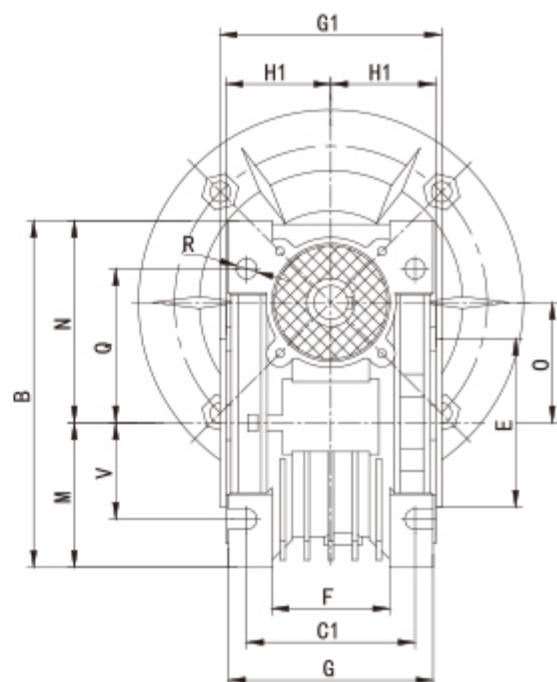
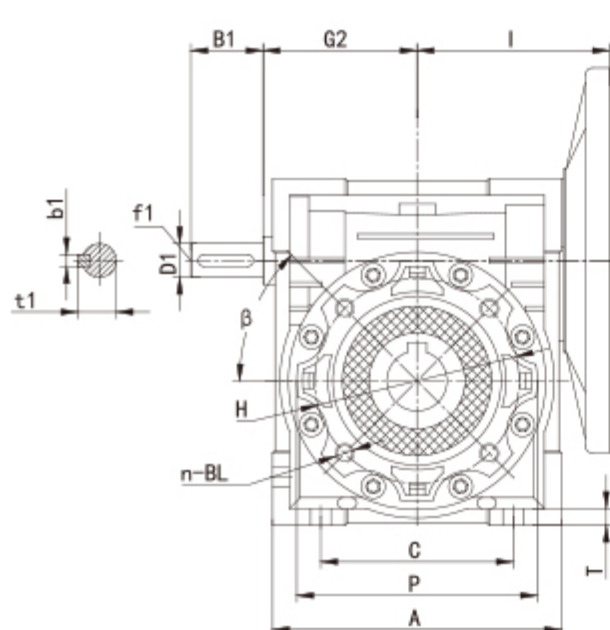

| RV-E | A | B | B1 | C | C1 | D(H8) | D1(j6) | E(+8) | F | G | G1 | G2 | H | H1 | I | M | N | O | P | Q | R | S | T | BL | β | b | b1 | t | t1 | f1 | V |
|------|-----|-------|----|-----|-----|--------|--------|-------|----|-----|-----|-----|-----|------|-------|-------|-------|-----|-----|-----|-----|------|-----|--------------|-----|-------|----|------------|------|-----|-----|
| 030 | 80 | 97 | 20 | 54 | 44 | 14 | 9 | 55 | 32 | 56 | 63 | 45 | 65 | 29 | 55 | 40 | 57 | 30 | 75 | 44 | 6.5 | 21 | 5.5 | M6X10 (n=4) | 0° | 5 | 3 | 16.3 | 10.2 | - | 27 |
| 040 | 100 | 121.5 | 23 | 70 | 60 | 18(19) | 11 | 60 | 43 | 71 | 78 | 53 | 75 | 36.5 | 70 | 50 | 71.5 | 40 | 87 | 55 | 6.5 | 26 | 6.5 | M6X10 (n=4) | 45° | 6 | 4 | 20.8(21.8) | 12.5 | - | 35 |
| 050 | 120 | 144 | 30 | 80 | 70 | 25(24) | 14 | 70 | 49 | 85 | 92 | 64 | 85 | 43.5 | 80 | 60 | 84 | 50 | 100 | 64 | 8.5 | 30 | 7 | M8X12 (n=4) | 45° | 8 | 5 | 28.3(27.3) | 16 | M6 | 40 |
| 063 | 144 | 174 | 40 | 100 | 85 | 25(28) | 19 | 80 | 67 | 103 | 112 | 75 | 95 | 53 | 95 | 72 | 102 | 63 | 110 | 80 | 8.5 | 36 | 8 | M8X12 (n=8) | 45° | 8 | 6 | 28.3(31.3) | 21.5 | M6 | 50 |
| 075 | 172 | 205 | 50 | 120 | 90 | 28(35) | 24 | 95 | 72 | 112 | 120 | 90 | 115 | 57 | 112.5 | 86 | 119 | 75 | 140 | 93 | 11 | 40 | 10 | M8X14 (n=8) | 45° | 8(10) | 8 | 31.3(38.3) | 27 | M8 | 60 |
| 090 | 206 | 238 | 50 | 140 | 100 | 35(38) | 24 | 110 | 74 | 130 | 140 | 108 | 130 | 67 | 129.5 | 103 | 135 | 90 | 160 | 102 | 13 | 45 | 11 | M10X16 (n=8) | 45° | 10 | 8 | 38.3(41.3) | 27 | M8 | 70 |
| 110 | 255 | 295 | 60 | 170 | 115 | 42 | 28 | 130 | - | 144 | 155 | 135 | 165 | 74 | 160 | 127.5 | 167.5 | 110 | 200 | 125 | 14 | 50 | 14 | M10X18 (n=8) | 45° | 12 | 8 | 45.3 | 31 | M10 | 85 |
| 130 | 293 | 335 | 80 | 200 | 120 | 45 | 30 | 180 | - | 155 | 170 | 155 | 215 | 81 | 179 | 146.5 | 187.5 | 130 | 250 | 140 | 16 | 60 | 15 | M12X20 (n=8) | 45° | 14 | 8 | 48.8 | 33 | M10 | 100 |
| 150 | 340 | 400 | 80 | 240 | 145 | 50 | 35 | 180 | - | 185 | 200 | 175 | 215 | 96 | 210 | 170 | 230 | 150 | 250 | 180 | 18 | 72.5 | 18 | M12X22 (n=8) | 45° | 14 | 10 | 53.8 | 38 | M12 | 120 |

NRV 产品介绍 / NRV PRODUCT INTRODUCTION

NRV尺寸 / NRV SIZE

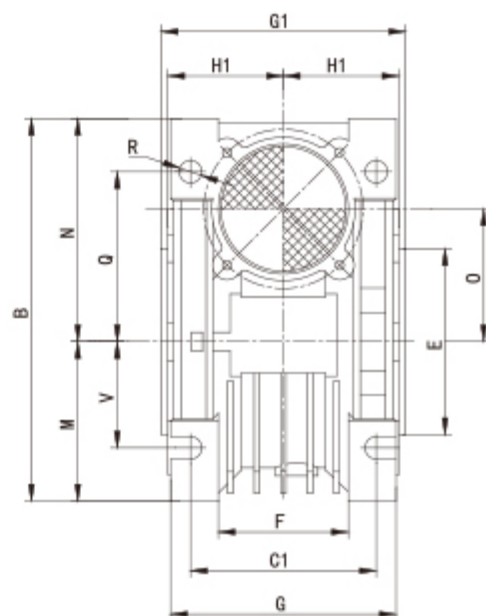
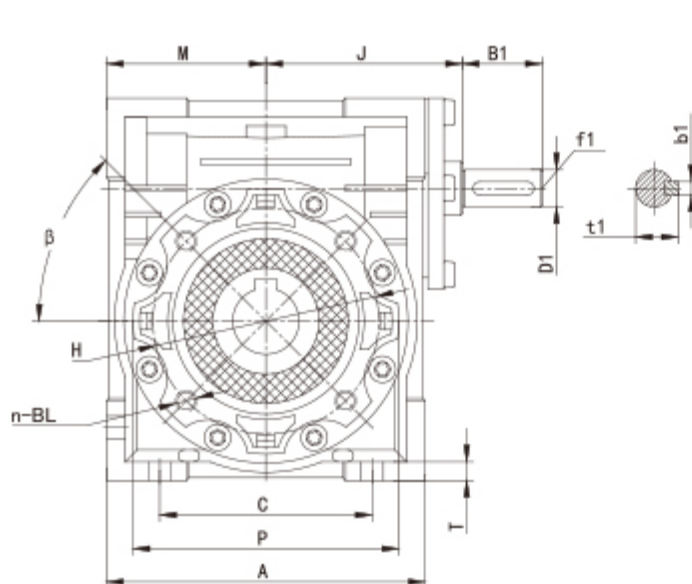

输出孔

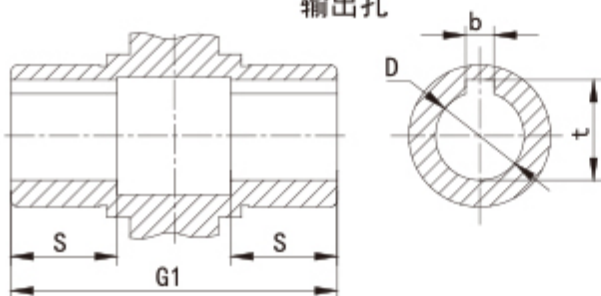

| NRV | A | B | B1 | C | C1 | D (H8) | D1 (H8) | E (h8) | F | G | G1 | H | H1 | J | M | N | O | P | Q | R | S | T | BL | β | b | b1 | t | t1 | f1 | V |
|-----|-----|-------|----|-----|-----|---------|---------|--------|----|-----|-----|-----|------|-----|-------|-------|-----|-----|-----|-----|------|-----|--------------|-----|--------|----|-------------|------|-----|-----|
| 030 | 80 | 97 | 20 | 54 | 44 | 14 | 9 | 55 | 32 | 56 | 63 | 65 | 29 | 51 | 40 | 57 | 30 | 75 | 44 | 6.5 | 21 | 5.5 | M6X10 (n=4) | 0° | 5 | 3 | 16.3 | 10.2 | - | 27 |
| 040 | 100 | 121.5 | 23 | 70 | 60 | 18 (19) | 11 | 60 | 43 | 71 | 78 | 75 | 36.5 | 60 | 50 | 71.5 | 40 | 87 | 55 | 6.5 | 26 | 6.5 | M6X10 (n=4) | 45° | 6 | 4 | 20.8 (21.8) | 12.5 | - | 35 |
| 050 | 120 | 144 | 30 | 80 | 70 | 25 (24) | 14 | 70 | 49 | 85 | 92 | 85 | 43.5 | 74 | 60 | 84 | 50 | 100 | 64 | 8.5 | 30 | 7 | M8X12 (n=4) | 45° | 8 | 5 | 28.3 (27.3) | 16 | M6 | 40 |
| 063 | 144 | 174 | 40 | 100 | 85 | 25 (28) | 19 | 80 | 67 | 103 | 112 | 95 | 53 | 90 | 72 | 102 | 63 | 110 | 80 | 8.5 | 36 | 8 | M8X12 (n=8) | 45° | 8 | 6 | 28.3 (31.3) | 21.5 | M6 | 50 |
| 075 | 172 | 205 | 50 | 120 | 90 | 28 (35) | 24 | 95 | 72 | 112 | 120 | 115 | 57 | 105 | 86 | 119 | 75 | 140 | 93 | 11 | 40 | 10 | M8X14 (n=8) | 45° | 8 (10) | 8 | 31.3 (38.3) | 27 | M8 | 60 |
| 090 | 206 | 238 | 50 | 140 | 100 | 35 (38) | 24 | 110 | 74 | 130 | 140 | 130 | 67 | 125 | 103 | 135 | 90 | 160 | 102 | 13 | 45 | 11 | M10X16 (n=8) | 45° | 10 | 8 | 38.3 (41.3) | 27 | M8 | 70 |
| 110 | 255 | 295 | 60 | 170 | 115 | 42 | 28 | 130 | - | 144 | 155 | 165 | 74 | 142 | 127.5 | 167.5 | 110 | 200 | 125 | 14 | 50 | 14 | M10X18 (n=8) | 45° | 12 | 8 | 45.3 | 31 | M10 | 85 |
| 130 | 293 | 335 | 80 | 200 | 120 | 45 | 30 | 180 | - | 155 | 170 | 215 | 81 | 162 | 146.5 | 187.5 | 130 | 250 | 140 | 16 | 60 | 15 | M12X20 (n=8) | 45° | 14 | 8 | 48.8 | 33 | M10 | 100 |
| 150 | 340 | 400 | 80 | 240 | 145 | 50 | 35 | 180 | - | 185 | 200 | 215 | 96 | 195 | 170 | 230 | 150 | 250 | 180 | 18 | 72.5 | 18 | M12X22 (n=8) | 45° | 14 | 10 | 53.8 | 38 | M12 | 120 |

NRV-E产品介绍 / NRV-E PRODUCT INTRODUCTION

NRV-E尺寸 / NRV-E SIZE

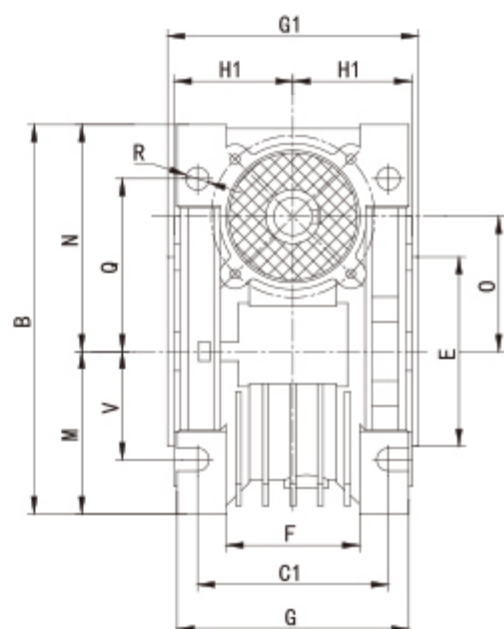
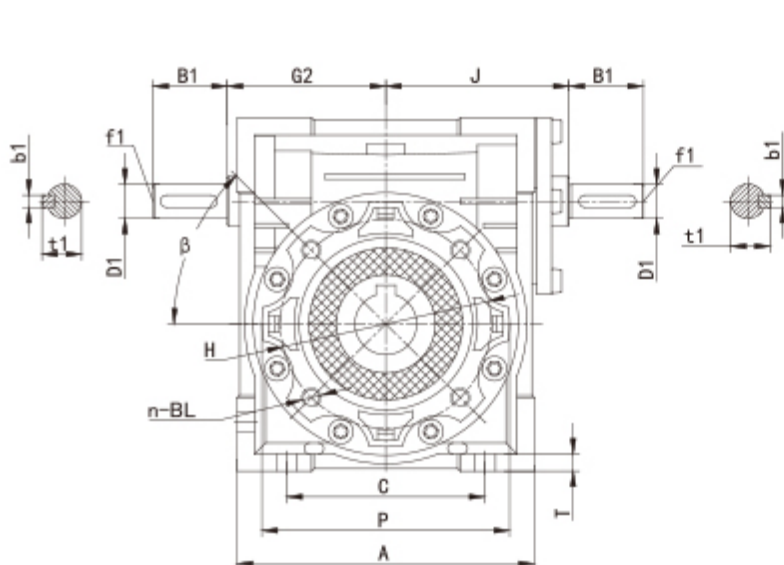

输出孔

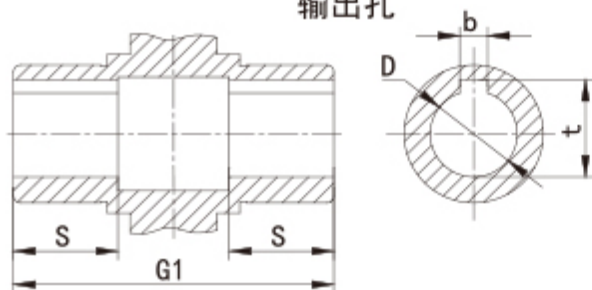

| NRV-E | A | B | B1 | C | C1 | D(HB) | D1(HB) | E(hB) | F | G | G1 | G2 | H | H1 | J | M | N | O | P | Q | R | S | T | BL | β | b | b1 | t | t1 | f1 | V |
|-------|-----|-------|----|-----|-----|--------|--------|-------|----|-----|-----|-----|-----|------|-----|-------|-------|-----|-----|-----|-----|------|-----|--------------|-----|-------|----|------------|------|-----|-----|
| 030 | 80 | 97 | 20 | 54 | 44 | 14 | 9 | 55 | 32 | 56 | 63 | 45 | 65 | 29 | 51 | 40 | 57 | 30 | 75 | 44 | 6.5 | 21 | 5.5 | M6X10 (n=4) | 0° | 5 | 3 | 16.3 | 10.2 | - | 27 |
| 040 | 100 | 121.5 | 23 | 70 | 60 | 18(19) | 11 | 60 | 43 | 71 | 78 | 53 | 75 | 36.5 | 60 | 50 | 71.5 | 40 | 87 | 55 | 6.5 | 26 | 6.5 | M6X10 (n=4) | 45° | 6 | 4 | 20.8(21.8) | 12.5 | - | 35 |
| 050 | 120 | 144 | 30 | 80 | 70 | 25(24) | 14 | 70 | 49 | 85 | 92 | 64 | 85 | 43.5 | 74 | 60 | 84 | 50 | 100 | 64 | 8.5 | 30 | 7 | M8X12 (n=4) | 45° | 8 | 5 | 28.3(27.3) | 16 | M6 | 40 |
| 063 | 144 | 174 | 40 | 100 | 85 | 25(28) | 19 | 80 | 67 | 103 | 112 | 75 | 95 | 53 | 90 | 72 | 102 | 63 | 110 | 80 | 8.5 | 36 | 8 | M8X12 (n=8) | 45° | 8 | 6 | 28.3(31.3) | 21.5 | M6 | 50 |
| 075 | 172 | 205 | 50 | 120 | 90 | 28(35) | 24 | 95 | 72 | 112 | 120 | 90 | 115 | 57 | 105 | 86 | 119 | 75 | 140 | 93 | 11 | 40 | 10 | M8X14 (n=8) | 45° | 8(10) | 8 | 31.3(38.3) | 27 | M8 | 60 |
| 090 | 206 | 238 | 50 | 140 | 100 | 35(38) | 24 | 110 | 74 | 130 | 140 | 108 | 130 | 67 | 125 | 103 | 135 | 90 | 160 | 102 | 13 | 45 | 11 | M10X16 (n=8) | 45° | 10 | 8 | 38.3(41.3) | 27 | M8 | 70 |
| 110 | 255 | 295 | 60 | 170 | 115 | 42 | 28 | 130 | - | 144 | 155 | 135 | 165 | 74 | 142 | 127.5 | 167.5 | 110 | 200 | 125 | 14 | 50 | 14 | M10X18 (n=8) | 45° | 12 | 8 | 45.3 | 31 | M10 | 85 |
| 130 | 293 | 335 | 80 | 200 | 120 | 45 | 30 | 180 | - | 155 | 170 | 155 | 215 | 81 | 162 | 146.5 | 187.5 | 130 | 250 | 140 | 16 | 60 | 15 | M12X20 (n=8) | 45° | 14 | 8 | 48.8 | 33 | M10 | 100 |
| 150 | 340 | 400 | 80 | 240 | 145 | 50 | 35 | 180 | - | 185 | 200 | 175 | 215 | 96 | 195 | 170 | 230 | 150 | 250 | 180 | 18 | 72.5 | 18 | M12X22 (n=8) | 45° | 14 | 10 | 53.8 | 38 | M12 | 120 |

NMRV025 小机型 / NMRV025 SMALL MODEL

RV

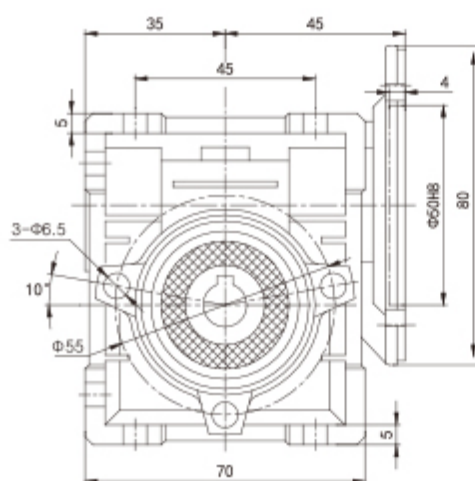

输入孔

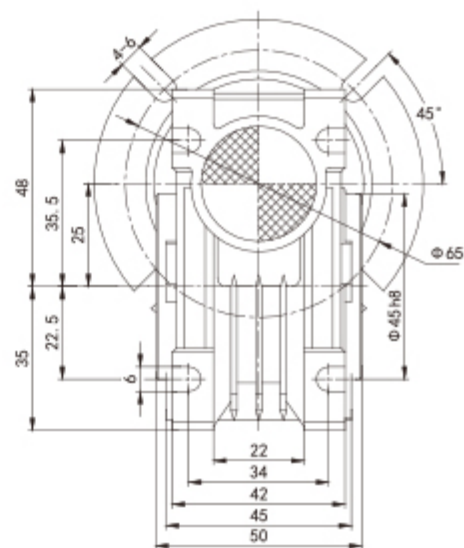
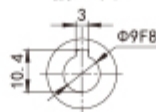

RV-E

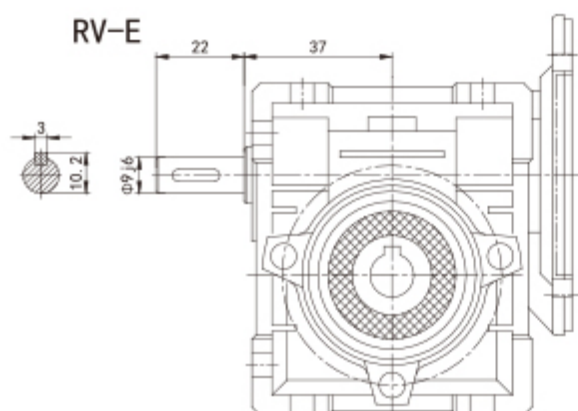

输出孔

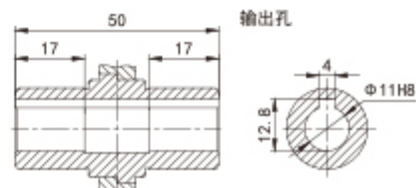

输出法兰 (FA)

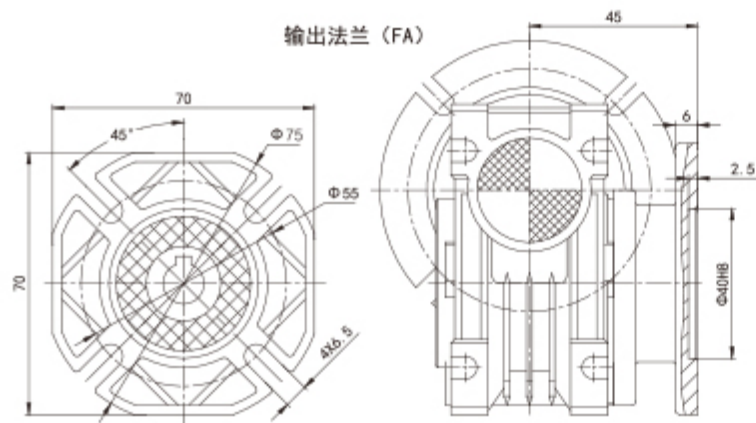

单向输出轴 (DZ)

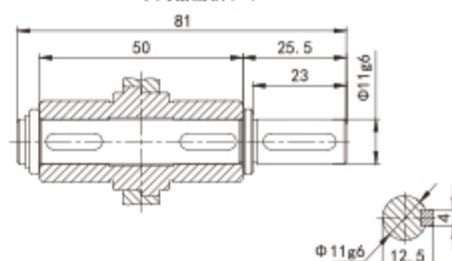

双向输出轴 (SZ)

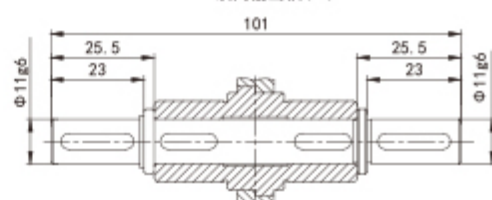

DRV 产品介绍 / DRV PRODUCT INTRODUCTION



不带电机
without the motor



带电机
with motor

DRV 型号说明 / DRV MODEL ILLUMINATE

DRV双蜗轮蜗杆减速机 / COMBINATION WORM GEAR UNITS



| | | | | | | | |
|-----|---------|-----|---|-----|-----|------|----|
| DRV | 050/110 | 900 | E | FA1 | DZ1 | 71B5 | B3 |
| ① | ② | ③ | ④ | ⑤ | ⑥ | ⑦ | ⑧ |

| NO | 说明 | Comments |
|----|--|--|
| 1 | 型号代码: DRV双联体蜗轮蜗杆减速机 | Model code: DRV duplex worm reducer |
| 2 | 蜗轮蜗杆减速机中心距(规格) | Central distance of worm gear units (spec) |
| 3 | 减速机速比 | Speed ratio of reducer |
| 4 | 1. 无代号表示不带蜗杆同向尾出轴 2. 带蜗杆同向尾出轴 | 1. No mark means single extension worm shaft 2. E: Double extension worm shaft |
| 5 | 1. 无代号表示不带输出法兰 2. FA, FB, FC, FD, FE (1/2): 输出法兰代号和位置 | 1. No mark means hole output flange 2. FA, FB, FC, FD, FE(1/2): output Flange and position |
| 6 | 1. 无代号表示孔输出 2. DZ(1/2): 单向输出轴和位置 3. SZ: 双向输出轴 | 1. No mark means hole output 2. DZ(1/2): Single output shaft and position 3. SZ: Double output shaft |
| 7 | 输入法兰规格型式 | Normalized form of input flange |
| 8 | 安装方位代号 | Installation position code |

DRV减速机选型表

DRV GEAR UNIT SELECTION TABLES

DRV性能参数 PERFORMANCE PARAMETERS

| P_{in} (kw) | n_1 (r/min) | i | M_{2n} (Nm) | F_{r2} (N) | f_s |  |  |
|------------------|------------------|------|------------------|-----------------|-------|---|---|
| 0.55 | 2.8 | 500 | 957 | 13500 | 1.6 | DRV063/130 | 8014 |
| | 1.9 | 750 | 1382 | 13500 | 1.2 | | |
| | 1.2 | 1200 | 2057 | 13500 | 0.8 | DRV063/150 | 8014 |
| | 0.8 | 1800 | 2638 | 18000 | 0.8 | | |
| | 0.6 | 2400 | 3182 | 18000 | 0.6 | | |
| 0.75 | 9.3 | 300 | 424 | 10320 | 2.8 | DRV050/110 | 8012 |
| | 7.0 | 400 | 553 | 10320 | 2.1 | | |
| | 5.6 | 500 | 640 | 10320 | 1.6 | | |
| | 4.7 | 300 | 838 | 10320 | 1.5 | DRV050/110 | 8024 |
| | 3.5 | 400 | 1105 | 10320 | 1.1 | | |
| | 2.8 | 500 | 1305 | 13500 | 1.1 | DRV063/130 | 8024 |
| | 2.3 | 600 | 1557 | 13500 | 1.0 | | |
| | 1.9 | 750 | 1772 | 13500 | 0.9 | | |
| | 1.6 | 900 | 2014 | 13500 | 0.8 | | |
| | 2.8 | 500 | 1291 | 18000 | 1.8 | | |
| | 2.3 | 600 | 1529 | 18000 | 1.7 | DRV063/150 | 8024 |
| | 1.9 | 750 | 1783 | 18000 | 1.3 | | |
| | 1.6 | 900 | 2215 | 18000 | 0.9 | | |
| | 1.2 | 1200 | 2680 | 18000 | 1 | | |
| 1.1 | 9.3 | 300 | 621 | 10320 | 1.9 | DRV050/110 | 8022 |
| | 7.0 | 400 | 810 | 10320 | 1.4 | | |
| | 5.6 | 500 | 938 | 10320 | 1.1 | | |
| | 4.7 | 300 | 1274 | 13500 | 1.3 | DRV063/130 | 90S4 |
| | 3.5 | 400 | 1621 | 13500 | 1.0 | | |
| | 2.8 | 500 | 1913 | 13500 | 0.8 | DRV063/150 | 90S4 |
| | 9.3 | 150 | 753 | 18000 | 3.1 | | |
| | 7 | 200 | 966 | 18000 | 2.4 | | |
| | 5.6 | 250 | 1175 | 18000 | 1.7 | | |
| | 4.7 | 300 | 1364 | 18000 | 1.7 | | |
| | 3.5 | 400 | 1619 | 18000 | 1.6 | | |
| | 2.8 | 500 | 1893 | 18000 | 1.2 | | |
| | 2.3 | 600 | 2242 | 18000 | 1.2 | | |
| | 1.9 | 750 | 2616 | 18000 | 0.9 | | |
| 1.5 | 9.3 | 300 | 878 | 13500 | 1.9 | DRV063/130 | 90S2 |
| | 7.0 | 400 | 1105 | 13500 | 1.4 | | |
| | 5.6 | 500 | 1305 | 13500 | 1.1 | | |
| | 4.7 | 300 | 1737 | 13500 | 1.0 | DRV063/130 | 90L4 |
| | 3.5 | 400 | 2210 | 13500 | 0.7 | | |
| | 9.3 | 150 | 1026 | 18000 | 2.3 | DRV063/150 | 90L4 |
| | 7 | 200 | 1317 | 18000 | 1.8 | | |
| | 5.6 | 250 | 1602 | 18000 | 1.3 | | |
| | 4.7 | 300 | 1860 | 18000 | 1.3 | | |
| | 3.5 | 400 | 2208 | 18000 | 1.2 | | |
| | 2.8 | 500 | 2582 | 18000 | 0.9 | | |
| | 2.3 | 600 | 3057 | 18000 | 0.9 | | |

DRV组合带电机安装方位

DRV COMBINED WITH MOTOR MOUNTING POSITION

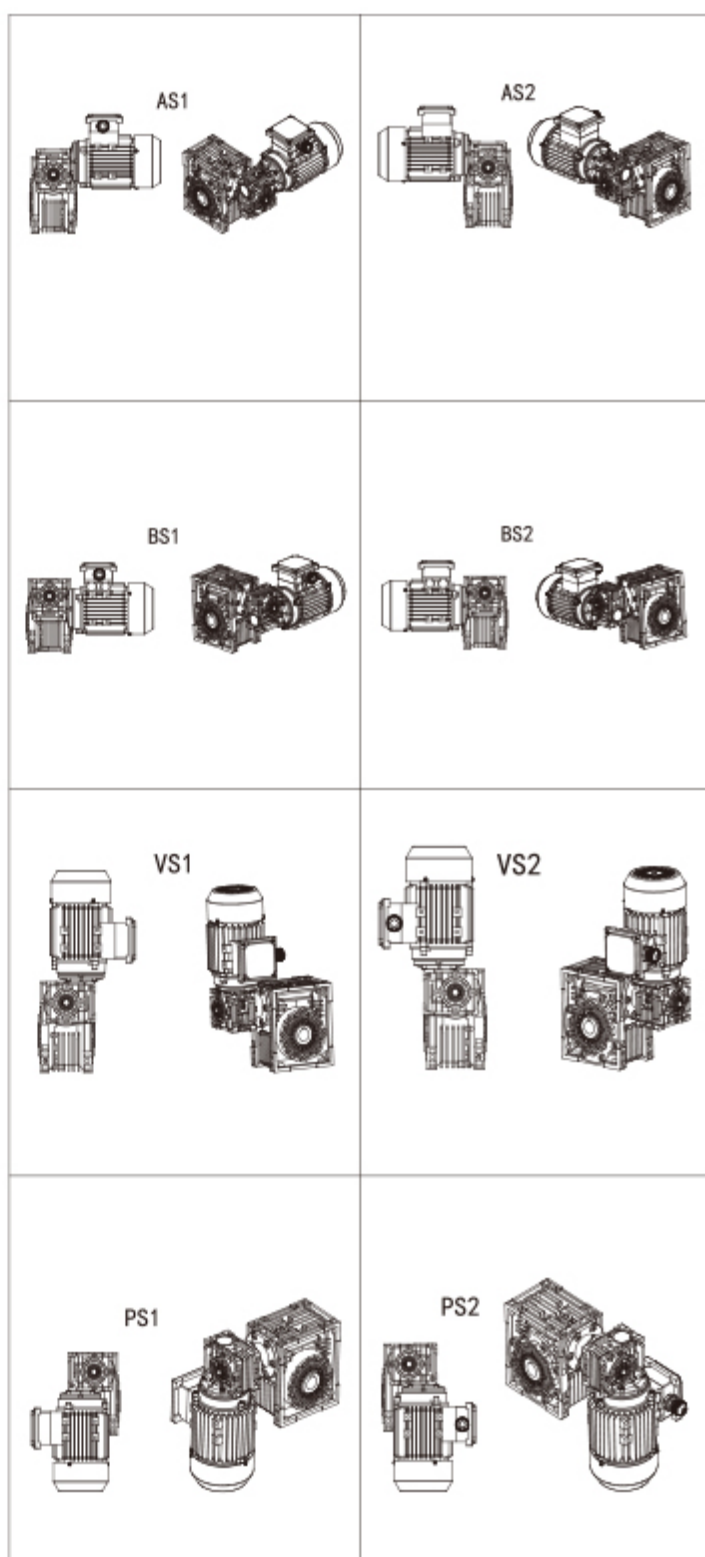

第一级和第二级减速机按上图方式组合，如在订货时没有特别说明，将按照AS2组合方式供货；
第二级减速机实际安装方式参照14页的安装方位图。

Note: the first stage and the second stage reducer according to the above combinations, such as when the ordering is not specified, will be in accordance with the AS2 combination supply; second stage reducer practical mode of installation 14 installation azimuth diagram.

DRV 尺寸 / DRV SIZE

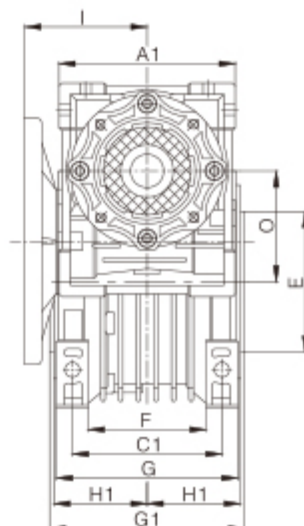
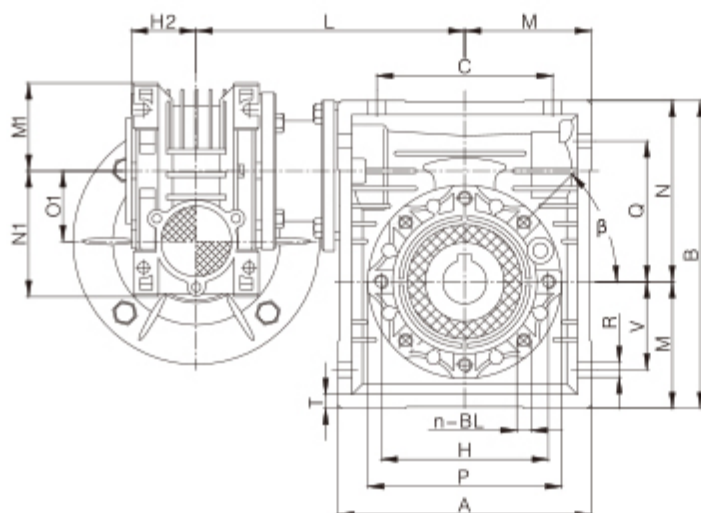

单向输出轴 (DZ)

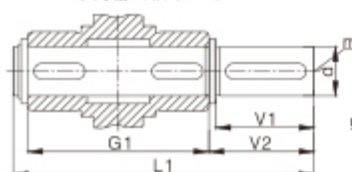

输出孔

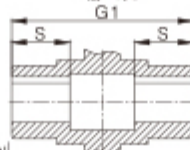

双向输出轴 (SZ)

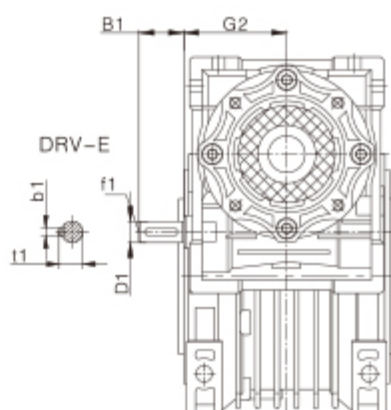
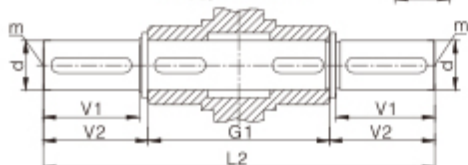

| DRV | A | A1 | B | B1 | C | C1 | D(H7) | D1(j6) | E(h8) | F | G | G1 | G2 | H | H1 | H2 | L | L1 | L2 | M | M1 | N | N1 | O | O1 |
|---------|-----|-----|-------|----|-----|-----|--------|--------|-------|----|-----|-----|----|-----|------|------|-----|-----|-----|-------|----|-------|------|-----|----|
| 025-030 | 80 | 70 | 97 | - | 54 | 44 | 14 | - | 55 | 32 | 56 | 63 | - | 65 | 29 | 22.5 | 100 | 102 | 128 | 40 | 35 | 57 | 48 | 30 | 25 |
| 025-040 | 100 | 70 | 121.5 | - | 70 | 60 | 18(19) | - | 60 | 43 | 71 | 78 | - | 75 | 36.5 | 22.5 | 115 | 128 | 164 | 50 | 35 | 71.5 | 48 | 40 | 25 |
| 030-040 | 100 | 80 | 121.5 | 20 | 70 | 60 | 18(19) | 9 | 60 | 43 | 71 | 78 | 51 | 75 | 36.5 | 29 | 120 | 128 | 164 | 50 | 40 | 71.5 | 57 | 40 | 30 |
| 030-050 | 120 | 80 | 144 | 20 | 80 | 70 | 25(24) | 9 | 70 | 49 | 85 | 92 | 51 | 85 | 43.5 | 29 | 130 | 153 | 199 | 60 | 40 | 84 | 57 | 50 | 30 |
| 030-063 | 144 | 80 | 174 | 20 | 100 | 85 | 25(28) | 9 | 80 | 67 | 103 | 112 | 51 | 95 | 53.0 | 29 | 145 | 173 | 219 | 72 | 40 | 102 | 57 | 63 | 30 |
| 040-075 | 172 | 100 | 205 | 23 | 120 | 90 | 28(35) | 11 | 95 | 72 | 112 | 120 | 60 | 115 | 57.0 | 36.5 | 165 | 192 | 247 | 86 | 50 | 119 | 71.5 | 75 | 40 |
| 040-090 | 206 | 100 | 238 | 23 | 140 | 100 | 35(38) | 11 | 110 | 74 | 130 | 140 | 60 | 130 | 67.0 | 36.5 | 182 | 234 | 309 | 103 | 50 | 135 | 71.5 | 90 | 40 |
| 050-110 | 255 | 120 | 295 | 30 | 170 | 115 | 42 | 14 | 130 | - | 144 | 155 | 74 | 165 | 74.0 | 43.5 | 225 | 249 | 324 | 127.5 | 60 | 167.5 | 84 | 110 | 50 |
| 063-130 | 293 | 144 | 335 | 40 | 200 | 120 | 45 | 19 | 180 | - | 155 | 170 | 90 | 215 | 81.0 | 53 | 245 | 265 | 340 | 146.5 | 72 | 187.5 | 102 | 130 | 63 |
| 063-150 | 340 | 144 | 400 | 40 | 240 | 145 | 50 | 19 | 180 | - | 185 | 200 | 90 | 215 | 96 | 53 | 275 | 297 | 374 | 170 | 72 | 230 | 102 | 150 | 63 |

| DRV | P | Q | R | S | T | BL | β | b | b1 | b2 | t | t1 | t2 | d(h6) | f1 | m | V | V1 | V2 |
|---------|-----|-----|-----|----|-----|----------------|---------|-------|----|----|------------|------|------|-------|----|-----|-----|----|------|
| 025-030 | 75 | 44 | 6.5 | 21 | 5.5 | M6 x 10 (n=4) | 0° | 5 | - | 5 | 16.3 | - | 16 | 14 | - | M6 | 27 | 30 | 32.5 |
| 025-040 | 87 | 55 | 6.5 | 26 | 6.5 | M6 x 10 (n=4) | 45° | 6 | - | 6 | 20.8(21.8) | - | 20.5 | 18 | - | M6 | 35 | 40 | 43 |
| 030-040 | 87 | 55 | 6.5 | 26 | 6.5 | M6 x 10 (n=4) | 45° | 6(6) | 3 | 6 | 20.8(21.8) | 10.2 | 20.5 | 18 | - | M6 | 35 | 40 | 43 |
| 030-050 | 100 | 64 | 8.5 | 30 | 7 | M8 x (n=4) | 45° | 8(8) | 3 | 8 | 28.3(27.3) | 10.2 | 28 | 25 | - | M10 | 40 | 50 | 53.5 |
| 030-063 | 110 | 80 | 8.5 | 36 | 8 | M8 x (n=8) | 45° | 8(8) | 3 | 8 | 28.3(31.3) | 10.2 | 28 | 25 | - | M10 | 50 | 50 | 53.5 |
| 040-075 | 140 | 93 | 11 | 40 | 10 | M8 x 14 (n=8) | 45° | 8(10) | 4 | 8 | 31.3(38.3) | 12.5 | 31 | 28 | - | M10 | 60 | 60 | 63.5 |
| 040-090 | 160 | 102 | 13 | 45 | 11 | M10 x (n=8) | 45° | 10 | 4 | 10 | 38.3(41.3) | 12.5 | 38 | 35 | - | M12 | 70 | 80 | 84.5 |
| 050-110 | 200 | 125 | 14 | 50 | 14 | M10 x 18 (n=8) | 45° | 12 | 5 | 12 | 45.3 | 16.0 | 45 | 42 | M6 | M16 | 85 | 80 | 84.5 |
| 063-130 | 250 | 140 | 16 | 60 | 15 | M12 x (n=8) | 45° | 14 | 6 | 14 | 48.3 | 21.5 | 48.5 | 45 | M6 | M16 | 100 | 80 | 85 |
| 063-150 | 250 | 180 | 18 | 72 | 18 | M12 x (n=8) | 45° | 14 | 6 | 14 | 53.8 | 21.5 | 53.5 | 50 | M6 | M16 | 120 | 82 | 87 |

UDL 产品介绍 / UDL PRODUCT INTRODUCTION



UDL系列无级变速器



UDL系列无级变速器



UDL系列+ NMRV系列蜗轮减速机



UDL系列+ NMRV系列蜗轮减速机

UDL 型号说明 / UDL MODEL ILLUMINATE

无级变速器 STEPLESS SPEED VARIATOR



| NO | 说明 | Comments |
|----|--------------------------|---|
| 1 | 无级变速器代号 | Code of stepless speed variator |
| 2 | L: 铝合金机壳 不标注时为铸铁机壳 | L:Aluminium alloy casing No mark means cast iron casing |
| 3 | 无级变速器机座号 | Steat NO. of stepless speed variato |
| 4 | B3: 底脚安装机型 B5: 法兰安装机型 | B3:Foot-mounted model B5:Flange-mounted positon |
| 5 | 电机功率 | Motor power |
| 6 | 电机接线盒位置, 默认位置1可以不写 | Position diagram for motor terminal box default position 1not to write out is ok |

UDL性能参数 / UDL PERFORMANCE PARAMETER

| 电机功率 Motor power | 型号 Model | i | n _r [r/min] | M _r (Nm) |
|------------------|----------|---------|------------------------|---------------------|
| 0.18KW | UDL002 | 1.6~8.2 | 880~170 | 1.5~3 |
| 0.25KW | UDL005 | 1.4~7 | 1000~200 | 2.2~6 |
| 0.37KW | UDL005 | 1.4~7 | 1000~200 | 3~6 |
| 0.55KW | UDL010 | 1.4~7 | 1000~200 | 4~8 |
| 0.75KW | UDL010 | 1.4~7 | 1000~200 | 6~12 |
| 1.1KW | UD020 | 1.4~7 | 1000~200 | 9~18 |
| 1.5KW | UD020 | 1.4~7 | 1000~200 | 12~24 |
| 2.2KW | UD030S | 1.4~7 | 1000~200 | 18~36 |
| 3.0KW | UD030L | 1.4~7 | 1000~200 | 24~48 |
| 4.0KW | UD030L | 1.4~7 | 1000~200 | 32~64 |
| 5.5KW | UD050S | 1.4~7 | 1000~200 | 45~90 |
| 7.5KW | UD050L | 1.4~7 | 1000~200 | 59~118 |

UDL与NMRV安装方位 / UDL AND NMRV INSTALLATION POSITION

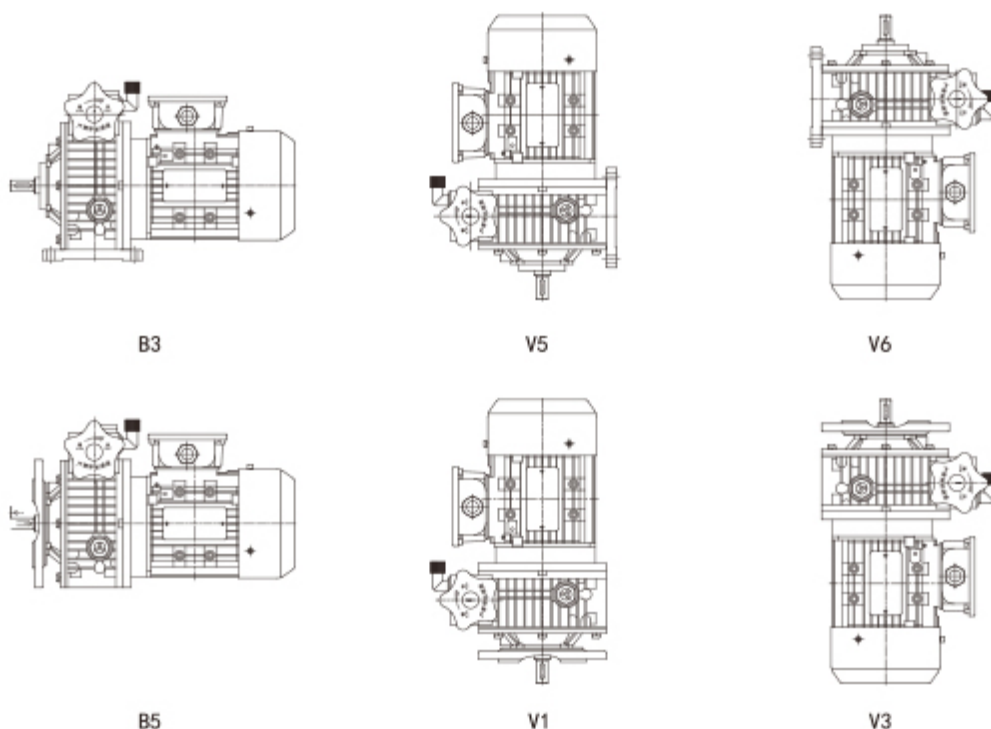

附件位置 / THE ATTACHMENT POSITION

手轮位置 / THE POSITION OF THE HAND WHEEL

电机接线盒位置 / MOTOR TERMINAL BOX POSITION

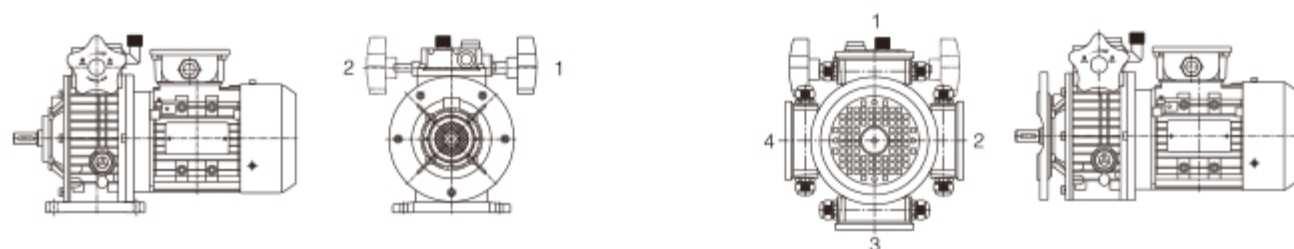

注:如没有特别说明,手轮将按照如图1位和B3安装方位的组合方式提供。

Note: if no special note, the handwheel will be in accordance with the figure 1 and B3 installation azimuth combination is provided.

UDL+NMRV 产品介绍

UDL+NMRV PRODUCT INTRODUCTION



UDL+NMRV 型号说明/UDL+NMRV MODEL ILLUMINATE

UDL-NMRV无级变速器与蜗轮蜗杆减速机组合

COMBINATION OF STEPLESS SPEED VARIATOR AND WORM GEAR UNITS

| | | | | | | | | | |
|----|---|-----|--------|-----|------|---|-----|-----|----|
| UD | L | 010 | - NMRV | 063 | - 40 | E | FA1 | DZ1 | B3 |
| ① | ② | ③ | ④ | ⑤ | ⑥ | ⑦ | ⑧ | ⑨ | ⑩ |

| NO | 说明 | Comments |
|----|---|---|
| 1 | 无级变速器代号 | Code of stepless speed variator |
| 2 | 铝合金机壳, 不标注时为铸铁机壳 | Aluminium alloy housing, and no mark means cast iron casing |
| 3 | 无级变速器机座号 | Continuously variable transmission model |
| 4 | 蜗轮蜗杆减速机代码 | Code of worm gear units |
| 5 | 蜗轮蜗杆减速机中心距 (规格) | Central distance of worm gear units(spec) |
| 6 | 蜗轮蜗杆减速机速比 | Speed ratio of worm gear units |
| 7 | 1.无代号表示不带输出法兰 2.E:带蜗杆同向输出轴 | 1.No mark means single extension worm shaft 2.E:Double extension worm shaft |
| 8 | 1.无代号表示不带输出法兰 2.FA、FB、FC、FD、FE (1/2):输出法兰代号和位置 | 1.No mark means without output flange 2.FA、FB、FC、FD、FE (1/2): Output flange and position |
| 9 | 1.无代号表示孔输出 2.DZ (1/2):单向输出轴和位置 3.SZ:双向输出轴 | 1.No mark means hole output 2.DZ(1/2):Single output shaft and position 3.SZ:Double output shaft |
| 10 | 安装方位代号 | Installation position code |

UDL 与 NMRV 安装方位

UDL AND NMRV INSTALLATION POSITION

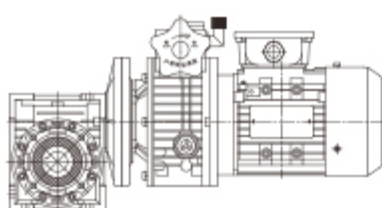

B3

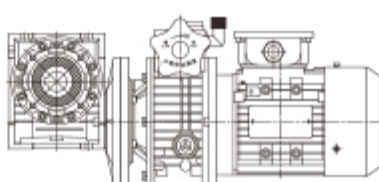

B8

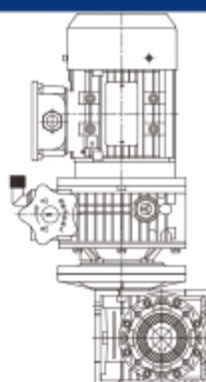

V5

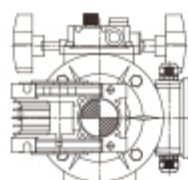

B6

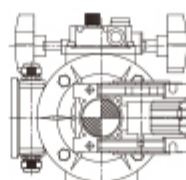

B7

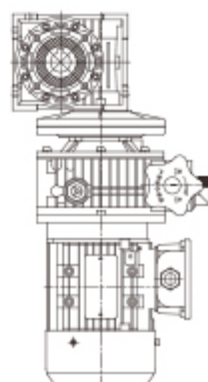

V6

附件位置 / THE ATTACHMENT POSITION

NMRV...UDL...手轮位置 / THE POSITION OF THE HAND WHEEL

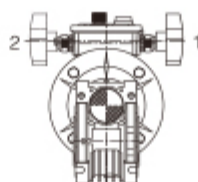
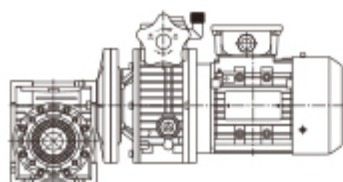

注:如没有特别说明,手轮将按照如图1位和B3安装方位的组合方式提供。

Note: if no special note, the handwheel will be in accordance with the figure 1 and B3 installation azimuth combination is provided.

NMRV...UDL...电机接线盒位置 / MOTOR TERMINAL BOX POSITION

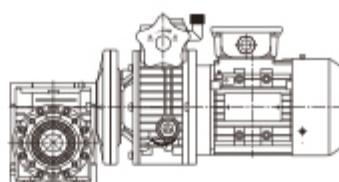
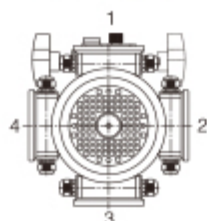

注:如对电机接线盒位置有特别要求,订购时须参考上图的要求指定接线盒方位,否则接线盒方位将按安装方位图表中的方位提供。

Note: if the motor terminal box position have special requirements, when ordering reference is made to the above requirements specified terminal box position, or junction box range according to installation position chart position is provided.

UDL+NMRV 尺寸 /UDL+NMRV SIZE

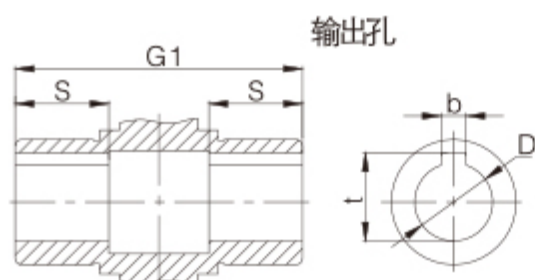
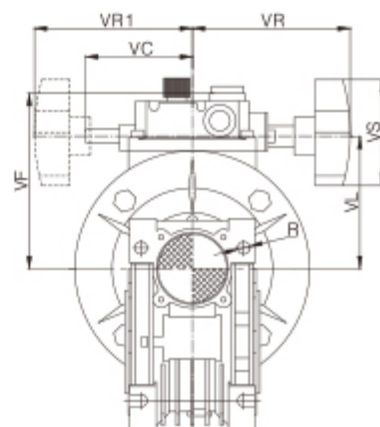
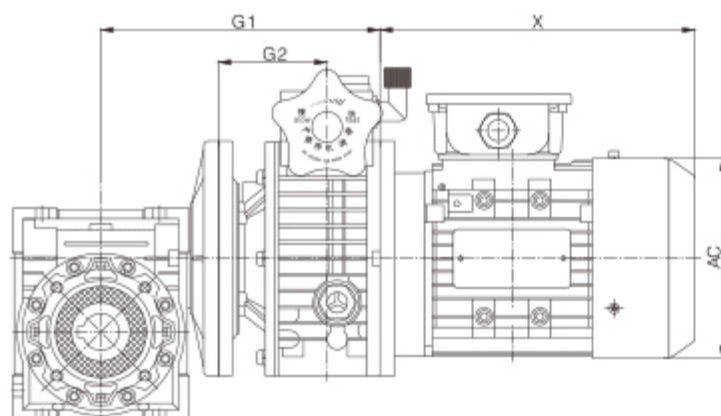

| 型号 (model) | D(H8) | b | t | G1 | G2 | S | VF | VL | VR | VR1 |
|----------------|--------|-------|------------|-------|-------|----|-----|-----|-----|-----|
| UDL002-NMRV030 | 14 | 5 | 16.3 | 167.5 | 119.5 | 21 | 111 | 78 | 110 | 110 |
| UDL002-NMRV040 | 18(19) | 6 | 20.8(21.8) | 182.5 | 134.5 | 26 | 111 | 78 | 110 | 110 |
| UDL005-NMRV040 | | | | 180 | 144 | | 123 | 90 | 110 | 110 |
| UDL002-NMRV050 | 25(24) | 8 | 28.3(27.3) | 192.5 | 144.5 | 30 | 111 | 78 | 110 | 110 |
| UDL005-NMRV050 | | | | 190 | 154 | | 123 | 90 | 110 | 110 |
| UDL005-NMRV063 | 25(28) | 8 | 28.3(31.3) | 205 | 169 | 36 | 123 | 90 | 110 | 110 |
| UDL010-NMRV063 | | | | 234 | 180.5 | | 140 | 107 | 120 | 120 |
| UDL005-NMRV075 | 28(35) | 8(10) | 31.3(38.3) | 222.5 | 186.5 | 40 | 123 | 90 | 110 | 110 |
| UDL010-NMRV075 | | | | 251.5 | 198 | | 140 | 107 | 120 | 120 |
| UD020-NMRV075 | | | | 300.5 | 227.5 | | 144 | 122 | 150 | - |
| UDL010-NMRV090 | 35(38) | 10 | 38.3(41.3) | 268.5 | 215 | 45 | 140 | 107 | 120 | 120 |
| UD020-NMRV090 | | | | 317.5 | 244.5 | | 144 | 122 | 150 | - |
| UDL010-NMRV110 | 42 | 12 | 45.3 | 299 | 245.5 | 50 | 140 | 107 | 120 | 120 |
| UD020-NMRV110 | | | | 348 | 275 | | 144 | 122 | 150 | - |
| UD030-NMRV110 | | | | 368 | 291 | | 188 | 150 | 160 | - |
| UD020-NMRV130 | 45 | 14 | 48.8 | 368 | 295 | 60 | 144 | 122 | 150 | - |
| UD030-NMRV130 | | | | 388 | 311 | | 188 | 150 | 160 | - |

注：1. NMRV的其它尺寸请参考24页

2. UDL的其它尺寸请参考57, 59页

3. X、AC尺寸请参考94页

PC-NMRV 产品概述 / PC-NMRV PRODUCTS OVERVIEW

材料 MATERIALS

铝合金外壳；齿轮：40Cr，基于渐开线精密制造。
Case in aluminium alloy. Gears:40Cr, machined accurately base on the accurate.



PC-NMRV 型号说明 / PC-NMRV MODEL ILLUMINATE

PC-NMRV 前置齿轮蜗轮蜗杆减速机

PC-NMRV WORM GEARS WITH PRE-STAGE HELICAL UNITS

| PC | 071 | NMRV | 075 | 40 | E | FA1 | DZ1 | B3 |
|----|-----|------|-----|----|---|-----|-----|----|
| ① | ② | ③ | ④ | ⑤ | ⑥ | ⑦ | ⑧ | ⑨ |

| NO | 说明 | Comments |
|----|--|--|
| 1 | 前置斜齿轮减速代号 | Helical Pre-stage unit |
| 2 | 电机座号 | Motor frame size |
| 3 | 型号代码： 1. RV孔输入带输入法兰 2. NRV轴输入不带输入法兰 | Model code 1. NMRV:Hole input with flange 2. NRV:Shaft input without flange |
| 4 | 减速机中心距（规格） | Central distance of worm gear units(spec) |
| 5 | 减速机速比 (i=5,7.5,10,15,20,25,30,40,50,60,80,100) | Speed ratio of reducer r(i=5,7.5;10;15;20;25;30;40;50;60;80;100) |
| 6 | 1. 无代号表示不带蜗杆同向尾出轴 2. E：带蜗杆同向尾出轴 | 1. No mark means single extension worm shaft 2. E: Double extension worm shaft |
| 7 | 1. 无代号表示不带输出法兰 2. FA,FB,FC,FD,FE(1/2):输出法兰号和位置 | 1. No mark means without output flange 2. FA,FB,FC,FD,FE(1/2):output Flange and position |
| 8 | 1. 无代号表示孔输出 2. DZ (1/2)：单向输出轴和位置 3. SZ：双向输出轴 | 1. No mark means hole output 2. DZ(1/2):Single output shaft and position 3. SZ:Double output shaft |
| 9 | 安装方位代号 | Installation position code |

PC接口尺寸 / PC CONNECTION SIZE

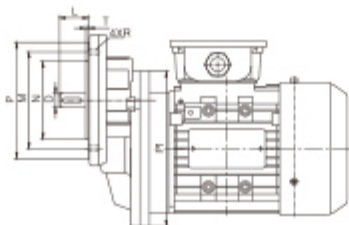
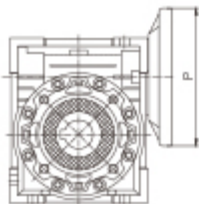

| TYPE | D(k6) | N(j6) | M | i | P | P1 | R | T | L |
|-------|-----------|-------|-----|------|-----|-----------|----|---|----|
| PC063 | 11(14) | 70 | 85 | 2.93 | 105 | 140(63B5) | M6 | 3 | 23 |
| PC071 | 14(19) | 80 | 100 | 2.94 | 120 | 160(71B5) | M6 | | 30 |
| PC080 | 19(24\28) | 110 | 130 | 3 | 160 | 200(80B5) | M8 | | 40 |
| PC090 | 24(19\28) | 110 | 130 | 2.45 | 160 | 200(90B5) | M8 | | 50 |

PC + NMRV尺寸 / SIZE OF PC + NMRV

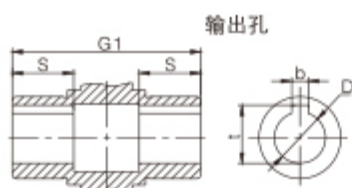
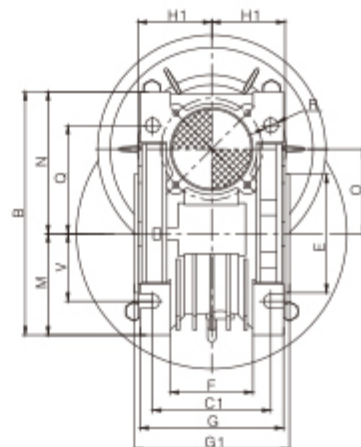
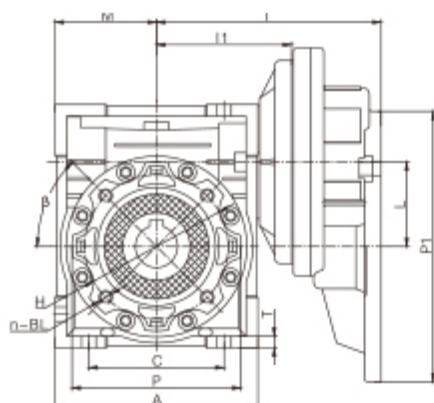

输出孔

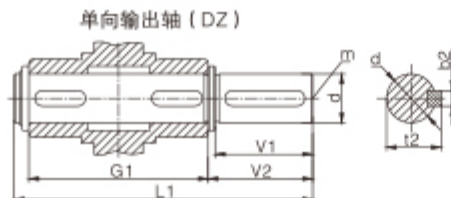

单向输出轴 (DZ)

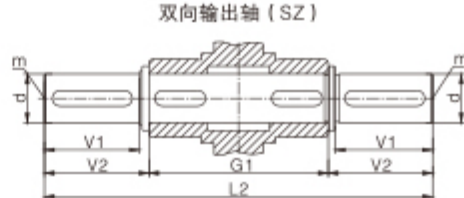

双向输出轴 (SZ)

| PC-NMRV | A | B | C | C1 | D(H7) | E(h8) | F | G | G1 | H | H1 | I | I1 | L | L1 | L2 | M | N | O | P | P1 | Q | R |
|--------------|-----|-------|-----|-----|--------|-------|----|-----|-----|-----|------|-------|-------|----|-----|-----|-------|-------|-----|-----|-----|-----|-----|
| 063-040 | 100 | 121.5 | 70 | 60 | 18(19) | 60 | 43 | 71 | 78 | 75 | 36.5 | 115 | 70 | 40 | 128 | 164 | 50 | 71.5 | 40 | 87 | 140 | 55 | 6.5 |
| 063-050 | 120 | 144 | 80 | 70 | 25(24) | 70 | 49 | 85 | 92 | 85 | 43.5 | 125 | 80 | 40 | 153 | 199 | 60 | 84.0 | 50 | 100 | 140 | 64 | 8.5 |
| 063-063 | 144 | 174 | 100 | 85 | 25(28) | 80 | 67 | 103 | 112 | 95 | 53.0 | 140 | 95 | 40 | 173 | 219 | 72 | 102 | 63 | 110 | 140 | 80 | 8.5 |
| 071-050 | 120 | 144 | 80 | 70 | 25(24) | 70 | 49 | 85 | 92 | 85 | 43.5 | 133 | 80 | 48 | 153 | 199 | 60 | 84.0 | 50 | 100 | 160 | 64 | 8.5 |
| 071-063 | 144 | 174 | 100 | 85 | 25(28) | 80 | 67 | 103 | 112 | 95 | 53.0 | 148 | 95 | 48 | 173 | 219 | 72 | 102 | 63 | 110 | 160 | 80 | 8.5 |
| 071-075 | 172 | 205 | 120 | 90 | 28(35) | 95 | 72 | 112 | 120 | 115 | 57.0 | 165.5 | 112.5 | 48 | 192 | 247 | 86 | 119 | 75 | 140 | 160 | 93 | 11 |
| 071-090 | 206 | 238 | 140 | 100 | 35(38) | 110 | 74 | 130 | 140 | 130 | 67.0 | 182.5 | 129.5 | 48 | 234 | 309 | 103 | 135 | 90 | 160 | 160 | 102 | 13 |
| 080-075 | 172 | 205 | 120 | 90 | 28(35) | 95 | 72 | 112 | 120 | 115 | 57.0 | 182 | 112.5 | 62 | 192 | 247 | 86 | 119 | 75 | 140 | 200 | 93 | 11 |
| 080-090 | 206 | 238 | 140 | 100 | 35(38) | 110 | 74 | 130 | 140 | 130 | 67.0 | 199 | 129.5 | 62 | 234 | 309 | 103 | 135 | 90 | 160 | 200 | 102 | 13 |
| 080(090)-110 | 255 | 295 | 170 | 115 | 42 | 130 | / | 144 | 155 | 165 | 74.0 | 229.5 | 160 | 62 | 249 | 324 | 127.5 | 167.5 | 110 | 200 | 200 | 125 | 14 |
| 080(090)-130 | 293 | 335 | 200 | 120 | 45 | 180 | / | 155 | 170 | 215 | 81.0 | 248.5 | 179 | 62 | 265 | 340 | 146.5 | 187.5 | 130 | 250 | 200 | 140 | 16 |

| PC-NMRV | S | T | BL | β | b | b2 | t | t2 | d(h6) | m | V | V1 | V2 |
|--------------|----|-----|-------------|---------|--------|----|------------|------|-------|-----|-----|----|------|
| 063-040 | 26 | 6.5 | M6X8(n=4) | 45° | 6(6) | 6 | 20.8(21.8) | 20.5 | 18 | M6 | 35 | 40 | 43.0 |
| 063-050 | 30 | 7 | M8X10(n=4) | 45° | 8(8) | 8 | 28.3(27.3) | 28.0 | 25 | M10 | 40 | 50 | 53.5 |
| 063-063 | 36 | 8 | M8X14(n=8) | 45° | 8(8) | 8 | 28.3(31.3) | 28.0 | 25 | M10 | 50 | 50 | 53.5 |
| 071-050 | 30 | 7 | M8X10(n=4) | 45° | 8(8) | 8 | 28.3(27.3) | 28.0 | 25 | M10 | 40 | 50 | 53.5 |
| 071-063 | 36 | 8 | M8X14(n=8) | 45° | 8(8) | 8 | 28.3(31.3) | 28.0 | 25 | M10 | 50 | 50 | 53.5 |
| 071-075 | 40 | 10 | M8X14(n=8) | 45° | 8(10) | 8 | 31.3(38.3) | 31.0 | 28 | M10 | 60 | 60 | 63.5 |
| 071-090 | 45 | 11 | M10X18(n=8) | 45° | 10(10) | 10 | 38.3(41.3) | 38.0 | 35 | M12 | 70 | 80 | 84.5 |
| 080-075 | 40 | 10 | M8X14(n=8) | 45° | 8(10) | 8 | 31.3(38.3) | 31.0 | 28 | M10 | 60 | 60 | 63.5 |
| 080-090 | 45 | 11 | M10X18(n=8) | 45° | 10(10) | 10 | 38.3(41.3) | 38.0 | 35 | M12 | 70 | 80 | 84.5 |
| 080(090)-110 | 50 | 14 | M10X18(n=8) | 45° | 12 | 12 | 45.3 | 48.5 | 42 | M16 | 85 | 80 | 84.5 |
| 080(090)-130 | 60 | 15 | M12X21(n=8) | 45° | 14 | 14 | 48.8 | 53.5 | 45 | M16 | 100 | 80 | 85.0 |

STANDARD MOTOR EXTERNAL REFERENCE DIMENSION

Technical drawing of a motor with dimensions labeled: A, B, C, D, E, F, G, H, I, J, K, L, M, N, O, P, Q, R, S, T, U, V, W, X, Y, Z.

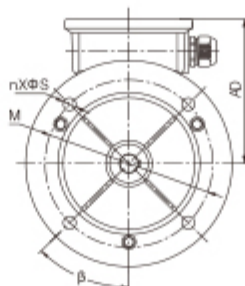

| 机座号 Frame size | 电机极数 Motor power | | | 外型尺寸 Forfilomtry | | | | 安装尺寸 Mounted size | | | | | | 轴伸尺寸 Shaft extension | | | | |
|-------------------|--------------------------|--------------|--------------|---------------------|-----|-----|-----|----------------------|-----|-----|---------|---|-----|-------------------------|---------|---------|-------|-------|
| | 2P | 4P | 6P | | | | | N | T | M | S | β | E | F | D | G | m | |
| | 电机功率 Motor poles (KW) | | | AC | AD | L | P | | | | | | | | | | | |
| 56 | 0.09 0.12 | 0.06 0.09 | | 113 | 96 | 199 | 120 | 80 | 3.0 | 100 | 7(n=4) | | 45° | 20 | 3 | 9 | 7.2 | M4X12 |
| 63 | 0.18 0.25 | 0.12 0.18 | 0.09 0.12 | 120 | 102 | 217 | 140 | 95 | | 115 | 10(n=4) | | | 23 | 4 | 11 | 8.5 | |
| 71 | 0.37 0.55 | 0.25 0.37 | 0.18 0.25 | 136 | 109 | 245 | 160 | 110 | | 130 | 40 | | | 5 | 14 | 11 | M5X12 | |
| 80 | 0.75 1.10 | 0.55 0.75 | 0.37 0.55 | 155 | 124 | 287 | | | 3.5 | | | | | 40 | 6 | 19 | 15.5 | M6X16 |
| 90S | 1.5 | 1.1 | 0.75 | 175 | 137 | 310 | 200 | 130 | | 165 | 12(n=4) | | | 50 | 8 | 24 | 20 | M8X19 |
| 90L | 2.2 | 1.5 | 1.1 | | | 335 | | | | | | | | | | | | |
| 100L | 3 | 2.2 3.0 | 1.5 | 195 | 151 | 383 | 250 | 180 | 4.0 | | | | | 215 | | 15(n=4) | | |
| 112M | 4 | 4.0 | 2.2 | 219 | 169 | 401 | | | | | | | | | | | | |
| 132S | 5.5 7.5 | 5.5 | 3.0 | 258 | 188 | 475 | 300 | 230 | | 265 | 19(n=4) | | | | 80 | | | 10 |
| 132M | | 7.5 | 4.0 5.5 | | | 513 | | | | | | | | | | | | |
| 160M | 11 15 | 11 | 7.5 | 315 | 242 | 609 | 350 | 250 | 5.0 | | | | | 300 | 19(n=4) | | 110 | |
| 160L | 18.5 | 15 | 11 | | | 653 | | | | | | | | | | | | |

Technical drawing of a motor showing dimensions: F, G, m, P, N, D, T, E, L, AC.

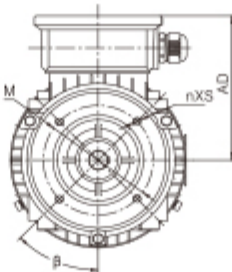

B14

| 机座号 Frame size | 电机极数 Motor power | | | 外型尺寸 Forfilomtry | | | | 安装尺寸 | | | | | 轴伸尺寸 | | | | | |
|-------------------|----------------------------|--------------|--------------|---------------------|-----|-----|-----|--------------|-----|-----|----------|-----|-----------------|----|----|------|-------|-----|
| | 2P | 4P | 6P | | | | | Mounted size | | | | | Shaft extension | | | | | |
| | 电机功率 Motor poles (KW) | | | AC | AD | L | P | N | T | M | S | β | E | F | D | G | m | |
| 56 | 0.09 0.12 | 0.05 0.09 | | 113 | 96 | 199 | 80 | 50 | 2.5 | 65 | M5(n=4) | 45° | 20 | 3 | 9 | 7.2 | M4X12 | |
| 63 | 0.18 0.25 | 0.12 0.18 | 0.09 0.12 | 120 | 102 | 217 | 90 | 60 | | 75 | | | | 23 | 4 | 11 | | 8.5 |
| 71 | 0.37 0.55 | 0.25 0.37 | 0.18 0.25 | 136 | 109 | 245 | 105 | 70 | | 85 | | | | 30 | 5 | 14 | | 11 |
| 80 | 0.75 1.10 | 0.55 0.75 | 0.37 0.55 | 155 | 124 | 287 | 120 | 80 | 3.0 | 100 | M6(n=4) | | 40 | 6 | 19 | 15.5 | M6X16 | |
| 90S | 1.5 | 1.1 | 0.75 | 175 | 137 | 310 | 140 | 95 | | 115 | MB(n=4) | | 50 | 8 | 24 | 20 | M8X19 | |
| 90L | 2.2 | 1.5 | 1.1 | | | 335 | | | | | | | | | | | | |
| 100L | 3 | 2.2 3.0 | 1.5 | | | 383 | | | 160 | | | | 110 | | | | | 130 |
| 112M | 4 | 4.0 | 2.2 | 219 | 169 | 401 | | | | | | | | | | | | |
| 132S | 5.5 7.5 | 5.5 | 3.0 | 258 | 188 | 475 | 200 | 130 | | 165 | M12(n=4) | | | 80 | 10 | 38 | 33 | |
| 132M | | 7.5 | 4.0 5.5 | | | 513 | | | | | | | | | | | | |
| 160M | 11 15 | 11 | 7.5 | | | 315 | | | 242 | | | | 609 | | | | | 250 |
| 160L | 18.5 | 15 | 11 | 653 | | | | | | | | | | | | | | |